

MILLER COUNTY AMBULANCE DISTRICT TYPE III AMBULANCE(S) RFP

Request for Proposals: New Type III Ambulance (s)
Closing Date: Monday, December 8th, 2014



P.O. Box 227, Eldon, MO 65026
Email: kjohnson@millercountyambulance.org

SPECIFICATIONS

FOR

2014 Type III New Ambulance

FOR ADDITIONAL INFORMATION CONTACT:

Kevin Johnson, District Administrator
573-392-7303
kjohnson@millercountyambulance.org

Closing Date/Time: December 8th, 2014 at 9:00 A.M. Local Time

MANUFACTURER'S COMPANY
NAME _____

REPRESENTATIVE _____

TELEPHONE
NUMBER _____

E-MAIL
ADDRESS _____

1. INTRODUCTION AND GENERAL INFORMATION

This document constitutes a Request for Proposals, (RFP), for the purchase of One (1) or Two (2) Type III ambulances, the final number to be determined based upon evaluation of the cost of the project; budget resources and the needs of the District.

- A. Organization – This document, referred to as an Request for Proposal, (RFP), is divided into the following parts:
 - 1. Introduction and General Information
 - 2. Signature Affidavit
 - 3. Specifications/General
 - 4. Request for Proposal Submission Information
 - 5. Pricing page(s)
 - 6. Terms and Conditions
 - 7. Signature
 - 8. Section II/Detailed Specifications
 - 9. Optional Features

Proposal Specifications:

- B. Although an attempt has been made to provide accurate and up-to-date information, District does not warrant or represent that the background information provided herein reflects all existing conditions related to this Request for Proposal.
- C. All manufacturers are to include in their proposal any and all costs associated with this project including but not limited to materials, equipment, freight, delivery, dealer preparation and set-up, and labor.
- D. Title: All equipment shall remain the property of the seller until delivered to and accepted by the District. Equipment supplied by the District shall remain the property of the District.
- E. Following this section is a “SIGNATURE AFFIDAVIT” form. In order to be considered for this RFP, you must fill out this form and include it with your submission.

Miller County Ambulance District is accepting Requests for Proposals for the purchase of One (1) or Two (2) 2014 or newer Type III ambulance vehicles based on the enclosed specifications.

The deadline for proposals is Monday, December 8th, 2014 at 9:00 a.m.

All proposal documents shall be sealed and submitted to:

**Miller County Ambulance District
Attention: Kevin Johnson, Administrator
P.O. Box 227
Eldon, MO 65026**

Street Address:

1304 South Aurora, Eldon, MO 65026

The signature affidavit on page 5 of this document must be completed and signed in order for the proposal to be accepted.

The Miller County Ambulance District reserves the right to reject any or all proposals when deemed to be in the best interest of the District.

Questions may be directed to:

Kevin Johnson, Administrator
P.O. Box 227
Eldon, MO 65026
573-392-7303
Email: kjohnson@millercountyambulance.org

Signature Affidavit

By submitting this proposal, we certify that the following:

- We have not directly or indirectly entered into any agreement or participated in any collusion or otherwise taken any action in restraint of free competition.
- No attempt has been made to induce any other person or firm to submit or not to submit a proposal.
- This proposal has been independently arrived at without collusion with any other competitor or potential competitor.
- This proposal has not been knowingly disclosed prior to the opening of proposals to any other manufacturer or competitor.
- Under the penalty of perjury, the above statements are accurate.

The undersigned, submitting this proposal, hereby agrees with all the terms, conditions and specifications required by the Miller County Ambulance District in this RFP, and declares that the attached proposal and pricing are in conformity therewith.

Name (Type or Print)	Title
----------------------	-------

Signature	Company or Firm
-----------	-----------------

Address

City	State	Zip
------	-------	-----

Telephone	Fax
-----------	-----

E-Mail

3. SPECIFICATIONS

- A. Unless otherwise specified, all units proposed shall be new, current manufacturer model year in undamaged condition, delivered to the Miller County Ambulance District, 1304 South Aurora, Eldon, MO 65026 and shall meet the following minimum specifications:

See Section II for Specification Details

- B. A complete set of specifications of the units including; drawings/measurements of the front, rear, streetside, curbside, and interior, descriptive literature, date of delivery and warranty information (including copies of the actual warranties and disclaimer to be issued) shall be included with the RFP submittal. All deviations or variances from the above specifications shall be expressly identified and explained. Any exception, clarification, or variation from these specifications shall be clearly indicated. Any exception, clarification, or variation must be described in writing with enough detail to enable Miller County Ambulance District to make an accurate evaluation of the impact to the new ambulance. If no exception, clarification, or variation is noted, it shall be understood that the delivered ambulance shall be in strict compliance with our specifications. Miller County Ambulance District shall be the sole judge of equality and our decision shall be final. Failure to provide this information may result in a proposal not being considered.

C. TRADE-IN EQUIPMENT

The following ambulances may at the option of the District be traded in. Trade-in equipment may be examined at the District headquarters, during regular business hours. Arrangements should be made to inspect the equipment by contacting Mark Maeder, Operations Manager at 573-392-7303.

Year/Make	Type	Approximate Mileage
2003 Ford E-450	Type III	259,220
2007 Ford E-450	Type III	***212,219
***Approximate Miles on Rebuilt Engine		82,000

4. REQUEST FOR PROPOSAL SUBMISSION INFORMATION

The District welcomes all interested parties to participate in its Request for Proposal process. Manufacturers will be expected to submit a proposal that is in compliance with the terms and conditions as outlined below:

- A. All awards are subject to final approval by the Board of Directors of Miller County Ambulance District, or their designated representatives(s).
- B. Proposal must be delivered to District Headquarters on or before the time and date stipulated in the Request for Proposal document. All late proposals will be rejected.
- C. Vendors may submit more than one proposal. No penalty or credit will be given for submitting multiple proposals.

- D. Manufacturers are responsible for reviewing their proposals prior to submission to be certain they can honor all price, terms and conditions offered in the proposal. Manufacturers may submit written amendments or withdraw their proposals up until the date and time of the scheduled RFP closing. Once proposals have been opened, all manufacturers will be expected to honor all prices and terms offered in total. Unit price will prevail in cases of extension errors. Proposal default will result in either temporary or permanent removal from the District's list of vendors in good standing.
- E. State of Missouri Sales Taxes are not applicable to sales made to Miller County Ambulance District and must be excluded.
- F. Please note that this request for proposals is being published and sent directly to a number of vendors. The District reserves the right to select the proposal determined to be the most advantageous to the District at its sole discretion. The selection process will be factored around acquisition costs, however, lowest cost is not the only factor that will be considered by the District. Miller County Ambulance District and its agents reserve the right to reject any or all proposals when deemed in the best interest of the District, purchase from any or all vendors, request additional information and to negotiate on behalf of the District.
- G. Qualifications of Manufacturer: Each manufacturer must submit with the proposal written evidence of qualifications to furnish the equipment and a list of previous customers of the type of units, equipment, or services bid. Manufacturers may be required to submit evidence that they have adequate financial and technical ability to furnish and service the equipment, maintain spare parts for maintenance and repair of the equipment, and have an acceptable service record on equipment previously supplied to others.
- H. A complete set of specifications of the units, descriptive literature, date of delivery and warranty information (including copies of the actual warranties and disclaimer to be issued) shall be included with the RFP submittal. **All deviations or variances from the above specifications shall be expressly identified and explained. Failure to provide this information may result in a proposal not being considered.**
- I. All questions about the meaning or intent of the Contract Documents or requirements are to be submitted in writing to the District Office not less than 14 days prior to the date of RFP opening.
- J. Withdrawal of Proposal: Proposals may be withdrawn by notice in writing only if received by the District prior to RFP opening. After RFP opening, proposals may not be withdrawn and shall remain open for 90 days after RFP opening.
- K. Request for Proposal Closes:

Proposals must be submitted by **9:00 A.M. local time on December 8th, 2014**. Only original proposals will be accepted. No copies or facsimile transmissions will be accepted. **All proposal documents shall be sealed and submitted to:**

**Miller County Ambulance District
Attention: Kevin Johnson, Administrator
P.O. Box 227
Eldon, MO 65026**

**Street Address:
1304 South Aurora, Eldon, MO 65026**

PROPOSALS RECEIVED AFTER THIS DATE AND TIME WILL NOT BE CONSIDERED.

- L. Offer: All proposals offered shall be firm for a minimum of ninety (90) calendar days after RFP closing date.
- M. Determination: Miller County Ambulance District reserves the right to be the sole determining party as to which proposal meet specifications. Any item, which, in the opinion of the management of the District, does not produce satisfactory results or services, may be returned to the successful manufacturer as not meeting specifications.
- N. Inquiries: All inquiries should be directed to:

Kevin Johnson, Administrator
Miller County Ambulance District
P.O. Box 227
Eldon, MO 65026
573-392-7303
Email: kjohnson@millercountyambulance.org

- O. Signature: All proposals must be signed by a duly authorized representative of the person, partnership or corporation offering the proposal. Failure to sign the Request for Proposal document will result in automatic disqualification of that proposal. The District reserves the right to request written confirmations of persons authorized to sign all proposals on behalf of a company.

5. PRICING

Based on the information and specifications given, proposals are to indicate pricing for one (1) and two (2) units:

\$ _____ DELIVERED PRICE EACH FOR ONE (1) UNIT

\$ _____ DELIVERED PRICE FOR TWO (2) UNITS

ALLOWANCE FOR TRADE-IN:

Allowance	Year/Make	Type	Approximate Mileage
\$ _____	2003 Ford E-450	Type III	259,220
\$ _____	2007 Ford E-450	Type III	***212,219
***Approximate Miles on Rebuilt Engine			82,000

Manufacture Model Color

Attach required submittals

Options Package or addenda

Delivery Date:

List any other additional costs associated with this project:

6. TERMS AND CONDITIONS

- A. Contract Terms: The performance of this Contract shall be governed solely by the terms and conditions set forth in the Contract notwithstanding any language contained in any invoice, shipping order, bill of lading or other document furnished by the Seller at any time. The Acceptance by the District of any goods furnished hereunder accompanied by any such document shall not be construed as an acceptance by the District of any terms or conditions contained in such document which are inconsistent with the terms and conditions set forth in this Contract. Any different or additional terms, other than those contained in the Contract, which are contained in any acceptance, acknowledgment, invoice or other document transmitted by Seller to the District are hereby objected to.

- B. Compliance with Specifications: No payment will be rendered for items delivered that fail to meet specifications as offered in proposal and all items delivered below specifications must be completely corrected or award will be forfeited to another manufacturer meeting specifications.
- C. Sellers Warranties: Seller expressly warrants that all articles, material and work covered by this contract will conform to each and every specification, drawing, sample or other description, which is furnished to or is adopted by the District and that they will be fit and sufficient for the purpose intended, merchantable, of good material and workmanship and free from defect. Such warranty shall survive delivery and shall not be deemed waived either by reason of the District's acceptance of said material or goods, or by payment for them.
- D. Bankruptcy or Insolvency: In the event of any proceedings by or against either party, voluntary or involuntary, in bankruptcy or insolvency, or for the appointment of a receiver or trustee or an assignee for the benefit of creditors, of the property of Seller, the District may cancel this Contract or affirm the Contract and hold Seller responsible in damages.
- E. Other: All proposals received by the RFP closing date and time will be considered, however, the District reserves the right to reject any and all proposals and to waive any informalities in the RFP process. All pages of this proposal are to be returned with the signature page filled out and signed. Failure to do so could result in disqualification of proposal.

7. SIGNATURE PAGE

I have read and understand this invitation for Request for Proposal and certify that I am a duly authorized representative of the person, partnership, or corporation offering this proposal:

Company

Address

City	State	Zip Code
------	-------	----------

Telephone Number	FAX Number	Email
------------------	------------	-------

Federal Tax ID Number	Signature/Title	Date Signed
-----------------------	-----------------	-------------

8. SECTION II
RFP DETAILED SPECIFICATIONS

1. Scope, Purpose and Classification

- 1.1. **Scope:** This specification covers one (1) or two (2) new commercially produced, ground medical care, hereinafter referred to as ambulance or vehicle. A vehicle in compliance with this specification shall be defined as a standard ambulance. This vehicle shall be in accordance with the Ambulance Design Criteria of the National Highway Traffic Administration, U.S. Department of Transportation, Washington D.C. This RFP specification is based on the Federal Ambulance Specification KKK-A1822-F revision.
- 1.2. **Purpose:** The purpose of this document is to provide the manufacturer with minimum specifications and test parameters that will meet the criteria to manufacture a vehicle as set forth by this agency. This agency seeks a vehicle that will deliver “fair value”. Fair value is defined by this agency as the manufacturer’s ability to provide a safe, functional, and practical ambulance conversion that will work in conjunction with the chassis specified at a reasonable cost. The specifications within this document are a basis to deliver such a vehicle to this agency. This agency at its discretion shall assess the intangible assets of the manufacturer such as, but not limited to; after quality, delivery support, customer service, parts availability, warranty, remounting capabilities, and turn-around time. The object is to provide a vehicle that is in accordance with nationally recognized guidelines.
- 1.3. **Classification:** This specifications call for the following type vehicle.
Type III– Integral Cab Chassis with modular ambulance body
Dual rear wheel driven
ALS elevating cot and squad bench

2. Requirements

- 2.1. **General:** This is an engineer, design, construct, and delivery type specification and is not the intention of this agency to write out vendors of similar or equal equipment of the types specified. It should be noted, however, that this specification is written around specific needs of this agency with the intent to standardize certain components. Therefore, in numerous places we have named specific brands of components. This has been done to establish a certain standard of quality. Other brands will only be accepted providing the vendor provides documentation in the proposal that the particular brand offered meets or exceeds the quality of the actual brand called for in the specification.
- 2.2. **Materials:** The ambulance, chassis, ambulance body, equipment, devices, medical accessories, and electronic equipment to be delivered under this contract shall be standard commercial product, which meet or exceed the requirements of this specification. The ambulance shall comply with all Federal Motor Vehicle Safety Standards (FMVSS), the Federal regulations applicable or specified for the year of manufacture. The chassis, components and optional items shall be as represented in the manufacturer’s current technical data. Materials used in the construction shall be new and not less than the quality conforming to current engineering and manufacturing practices. Materials shall be free of defects and suitable for service intended.
- 2.3. **Manufacturing Ability:** It is the intent of these specifications that the manufacturer of this vehicle has the ability to remount and refurbish a complete ambulance within their plant or facility, except the chassis. The ambulance manufacturer must have significant experience in the remounting and refurbishment of modular ambulance bodies. The location of remounting facilities should be within reasonable proximity to the District and clearly identified within the proposal.

- 2.4. Service/Repair: Manufacturer shall have service facilities to service the units and/or provide warranty work within reasonable proximity to the District. The location of these facilities shall be clearly identified within the proposal. Additionally, the manufacturer should also specify the availability of a loaner units in these events.
- 2.5. References: As further evidence of the manufacturer's ability to fulfill its obligations, the manufacturer contractor shall submit a list of customers with similar type ambulance conversion units. The references shall also include name of service, address, contact, and phone number.
- 2.6. Exceptions to Specifications: Any exceptions to these specifications indicated must be clearly pointed out. Otherwise, it will be considered that items offered are in strict compliance with these specifications and the successful manufacturer will be held responsible for delivering a vehicle meeting these specifications. Any exception must reference by item number and be explained in detail on a separate sheet marked "Exceptions."

3. Price, Warranty and Payment:

- 3.1. All proposal prices shall be complete and include warranty and delivery of the completed vehicle.
- 3.2. Payment shall be made in accordance with these specifications and the proposal submitted by the manufacturer. Payment will be made upon acceptance of the vehicle and equipment specified under these specifications.
- 3.3. All proposal price and conditions must be specified on the Request for Proposal Form. Proposal prices shall be valid for at least 90 days from the date of RFP opening, or as otherwise specified on the Request for Proposal Form.
- 3.4. Full payment will be made when unit is received, inspected and found to comply with procurement specifications, free of damage and properly invoiced.
- 3.5. A penalty of One hundred dollars (\$150.00) per day shall be assessed against manufacturer for each day past completion date that work is not completed.
- 3.6. Warranty: The successful manufacturer shall provide a manufacturer's warranty coverage for the ambulance conversion, which shall at a minimum include:

A limited Warranty shall be provided on the aluminum fully welded modular body for a period of twenty years. The manufacturer shall warrant to the original retail purchaser that, for a period of twenty years from the date of delivery, the ambulance fully aluminum welded modular body shall be free of substantial defects in materials and workmanship, which is attributable to the Warrantor manufacturer work and which arise during the course of normal use and service. There shall be a copy of the Warranty statement included in the proposal document as well as the location of the closest approved warranty center.

There shall be a seven year, 70,000 mile conversion warranty which includes the electrical wiring system, paint and graphics with an effective starting date as the date the District accepts delivery of the completed vehicle. It is the intent of this requirement that items not manufactured or installed by the ambulance manufacturer be excluded. There shall be a copy of the Warranty statement included as part of the proposal document.

Warranty on the chassis portion of the completed ambulance shall be the responsibility of the chassis manufacturer.

- 3.7. Insurance: All manufacturers shall have in place product liability insurance. *Copy of insurance certification to be provided with proposal.*
- 3.8. Delivery: The delivery schedules that are submitted by the manufacturer and agreed upon by the District shall automatically become binding upon the successful manufacturer. Manufacturer shall provide in writing to accompany this document a proposed delivery time. The delivery time proposal will include the transit time of the finished vehicle.

CHASSIS

Miller County Ambulance District currently utilizes a Chevrolet G3500 chassis with a 6.6 Duramax Turbo Diesel for its primary fleet. It is not the intention of this agency to write out vendors of similar or equal equipment of the types specified. It should be noted, however, that this specification is written around specific needs of this agency with the intent to standardize certain components of the fleet and to provide for opportunities of remounting. Therefore, in numerous places we have named specific brands of components. This has been done to establish a certain standard of quality. Other brands will only be accepted providing the vendor provides documentation in the proposal that the particular brand offered meets or exceeds the quality of the actual brand called for in the specification.

Miller County Ambulance will give consideration to the following chassis options.

- 1. 2014 or newer GM G3500 Duramax Diesel/Ambulance Prep Package – G3500 Cargo with dual rear wheels; 139” wheel base and front stabilizer bar.
- 2. Vendors/manufacturers may submit more than one proposal for an alternate chassis/engine option as, referenced in Section 3/Item C, provided that the conversion does not exceed the following dimensions:

Dimensions/Exterior

Overall vehicle length:	264 inches
Overall vehicle height:	105 inches
Overall module body length:	148 inches
Overall module body height:	88 inches
Overall module body width:	96 inches

4. CHASSIS – TYPE III

- 4.1. 2014 Chevrolet G3500 or Newer/YF2 Ambulance Prep Package
- 4.2. Highest Trim Level available
- 4.3. 139" Wheelbase dual rear wheel.
- 4.4. Duramax 6600 Turbo-Diesel engine
- 4.5. 12,600 lbs. G.V.W.R.
- 4.6. Dual 145 Amp Alternators.

- 4.7. (3) 650 Amp Batteries; 1-Under Hood & 2- in Exterior Compartment Battery Drawer.
- 4.8. Engine Block Heater/Part of YF2 Package.
- 4.9. 6- Speed Electronic Automatic Transmission with Overdrive
- 4.10. Transmission Oil Cooler.
- 4.11. Rear Wheel Drive.
- 4.12. Locking Differential
- 4.13. 3.73 Axle Ratio.
- 4.14. 33 Gallon Fuel Tank.
- 4.15. Stainless Steel Exhaust.
- 4.16. Power-assisted recirculating ball steering.
- 4.17. 4 wheel disc brakes with front vented discs.
- 4.18. Independent front suspension.
- 4.19. Front coil springs with front stabilizer bar.
- 4.20. HD front shocks.
- 4.21. Rigid rear axle.
- 4.22. Rear leaf spring suspension.
- 4.23. HD rear shocks.
- 4.24. Front and rear 16.0" x 6.0" silver steel wheels.
- 4.25. LT225/75R16.0E BSW front and rear tires with STEEL VALVE STEMS.
- 4.26. 4-wheel anti-lock braking system.
- 4.27. Dual airbags.
- 4.28. Front height adjustable seatbelts with pretensioners.
- 4.29. Air Conditioning
- 4.30. Rear Air Conditioning and Heating Modifier Connections.

- 4.31. AM/FM CD stereo, clock, seek, scan, fixed antenna.
- 4.32. Cruise control
- 4.33. Tilt Steering Wheel
- 4.34. Power door locks and Power Windows
- 4.35. Analog instrument display includes oil pressure gauge, water temperature gauge, voltmeter, and trip odometer.
- 4.36. Warning indicators include oil pressure, water temperature, battery, key in ignition, and door ajar.
- 4.37. Intermittent windshield wipers
- 4.38. Day-night rearview mirror.
- 4.39. Interior lights including dome light.
- 4.40. O.E.M. Cloth Captains seats with fixed headrests, driver and passenger armrests.
- 4.41. Vinyl door trim, full cloth headliner.
- 4.42. O.E.M. Rubber Cab Flooring
- 4.43. Front license plate bracket.
- 4.44. Black door handles.
- 4.45. Chrome grille.
- 4.46. Dual Velvac Euro-style Power, Heated w/ Turn Signal Rear View Mirrors with Convex.
- 4.47. Chrome Front Bumper
- 4.48. Aero-composite halogen headlamps
- 4.49. Rear Mud Flaps
- 4.50. Diamond Treadplate Running Boards with Fender Flair and Grip Strut Inserts
- 4.51. Phoenix Stainless Steel Wheel Covers
- 4.52. Valve Extenders for Dual Rear Wheels

DOES YOUR PROPOSAL COMPLY WITH ALL SECTIONS EXACTLY? YES _____ NO _____

5.1.MODULAR BODY

- 5.2. Cab Height Walk-Through
- 5.3. All Aluminum, Fully Welded Modular Body
- 5.4. 145” Long X 92” Wide with 68” Headroom and 48” Aisle Width
- 5.5. .125” X 2” X 2” Extruded Frame on 12” Centers; 6061T6 Material
- 5.6. Quarter Round Extruded Corner Post with Internal Web Member; 6063T6 Material
- 5.7. Roof Corner Extrusion to Include a Drip Rail; 6063T6 Material
- 5.8. Module Mounting Plates 1” x 3” Solid Aluminum; 6061T6 Material
- 5.9. Floor Structure .25” x 1.5” x 3”; 6061T6 Material
- 5.10. Extruded Door Jambs, Minimum .375” Thick with .125” Flange; 6061T6 Material
- 5.11. Extruded Door Frames with Skin Bent around Edges and Welded on Back Side Door Skins to be Stretched and wrapped around the door frame without cutting and welding seams.
- 5.12. Corner Splines of Solid Milled Aluminum with 90 Degree Setting and Gripping Teeth Located in all 4-corners of all Door Frame and Jamb Extrusions
- 5.13. 4” Welding on all Frame Members
- 5.14. .125” Single Sheet Side Skins and Roof 5052H32
- 5.15. Side Skins have 12” stitch weld around the interior Perimeter with VHB, and Stigaflex on Frame Members
- 5.16. Roof is Completely Seam Welded, ground smooth with VHB on Frame Members
- 5.17. .25” Gussets
- 5.18. .50” Tapping Plates
- 5.19. .050” Exterior Sub Floor
- 5.20. Two (2) on Each Side .50” x 4” Side Impact Rails; 6061T6 Material

EXTERIOR COMPARTMENTS

- 5.21. Streetside Front-(**M-1**) – 58.6” High x 20.7” Wide x 17” Deep
“H” Size Oxygen Bottle Bracket
- 5.22. Street side Rear-(**M-3**) – 75.8” High x 20” Wide x 17” Deep
Compartment Floor Paned Down 4”
2” Webb Strap w/ Chrome Metal Seat Belt Buckle
Back Board Storage
- 5.23. Curbside Rear-(**M-5**) – 23” High x 38” Wide x 17” Deep
Double Doors
- 5.24. Curbside Front-(**M-7**) – 44.6” High x 18.3” Wide x Inside Outside Access
Interior / Exterior Cabinet
- 5.25. Curbside Front Lower-(**M-8**) – 12.1” High x 18” Wide x 19.4” Deep
Battery Roll-out Drawer
- 5.26. All Compartments have Smooth Sweep-Out Floors and Diamond Tread plate walls Back
Board Compartments will have .25” thick Floor
- 5.27. Compartments to be welded into place
- 5.28. Polished Aluminum Drip Rail above Each Compartment
- 5.29. Compartment Lighting in All Compartments w/ Recessed in both Back Board
Compartments
- 5.30. All Compartment Lighting Will be Intertek LED
- 5.31. Heavy-Duty Chrome Tri-Mark 850 Paddle Latches with .25” Thick Straight Activation
Rods
- 5.32. Rear Access Door Opening 56” High x 48” Wide
- 5.33. Curbside Access Door Opening 73” High x 31” Wide
- 5.34. Exterior Paddle Latches on ALL Doors & Interior Latch with Locking Device on All
Entry Doors
- 5.35. Double Rotary Locks with Hex Head Striker Pins on ALL Doors
- 5.36. Door Rotary Locks to be located inside of Door Gaskets
- 5.37. Full Perimeter Single Piece TPV Door Gaskets located on the Door

- 5.38. Dual Striker Pins and Rotary Door Latches on all Tall or Double Doors
- 5.39. Machine Thread Fasteners on All Doors; Minimum ¼ Bolts on Hinges
- 5.40. Heavy-Duty Gas Strut Hold Opens, All Compartment Doors and Curbside Entry Door
- 5.41. Dual Austin Grabber Hold Opens; Rear Doors

MISCELLANEOUS

- 5.42. Machined Louvered Vents for Oxygen, Intake, and Exhaust Vents
- 5.43. Lower Body Rub Rails mounted under Body
- 5.44. Polished Fender Flairs
- 5.45. Combination Rear Step / Bumper; Steel Frame with Diamond Treadplate Pontoons
- 5.46. Flip-up Rear Open-Grate Step with Red and White Diamond Reflective Tape
- 5.47. Stainless Steel Thresholds on Rear and Curbside Entry Doors
- 5.48. Fixed Upper Window in Curbside Door; Tinted Safety Glass
- 5.49. Fixed Upper Windows in Rear Doors; Tinted Safety Glass
- 5.50. ECK Electrolysis Prevention Coating on Exterior Hardware
- 5.51. Nutcerts on All Body Hardware Screw Fastener
- 5.52. Huck Bolt Rivets for Kickplates, Stone and Corner Guards
 - .090” Bright Diamond Treadplate Aluminum:
 - Rear Kick plate; Full Width from Door Threshold Down
 - Front Stone Guards, 17” High
 - Corner Guards, 17” High
 - Lower Body Rub Rails 1 ½” High x 2” Wide

DOES YOUR PROPOSAL COMPLY WITH ALL SECTIONS EXACTLY? YES _____ NO _____

ELECTRICAL

- 6.1. All Wiring Colored Coded by Function
- 6.2. Wire Name and Number stamped every 4" to 6"
- 6.3. All Wiring run in 300 Degree Split Loom
- 6.4. Self-diagnostic Printed Circuit Board, Point to Point Wiring System with Lifetime Warranty
- 6.5. Common Ground for all Electrical to run from Panel to Chassis Frame Rail
- 6.6. Master Switch to be Located in Front and Action Area Switch Panels
- 6.7. Whelen 600 Series LED Rear Brake, Tail, and Amber Arrow Turn Signals
- 6.8. L.E.D. Clearance Lights
- 6.9. Kinequip LED Side Marker Lights Red
- 6.10. Kinequip LED Third Break Light Over the Rear Doors
- 6.11. Hella Amber 550 Fog Lights
- 6.12. (6) Whelen 900 Series 8-32 Scene Lts; 2-Each Side& 2-Rear
- 6.13. Rearmost Scene Light on Each Side & Both Rear Scene Lights to be Reverse Activated
- 6.14. Cab Engine Cover Console for Switch, Gauges, Siren, and Two-Way Radios
- 6.15. Add-on Console for Drink Holders, Portable Radios, and Notebook Storage
- 6.16. Both Consoles to be fastened with Cam-over heavy-duty rubber soft latches
- 6.17. Digital Ammeter and Voltmeter
- 6.18. (2) Stereo Speakers located in the Center Head Liner of the Patient Compartment, Volume Control Knob Located in the Action Area
- 6.19. Rear Action Area Console for Switches, Oxygen, Suction, 12 SDC & 110 VAC Outlets
- 6.20. Digital Thermostat for Rear H.V.A.C. System
- 6.21. Hand Held Spot Light, Eagle Eye, Rubber Housing, Hard Wired to the Driver Seat Base
- 6.22. (2) Cab Over Head Lights, Kinequip Red/White LEDs

- 6.23. (6) Intertek LED Dome Lights; 3-Each Side, Switch Separate; 15 Minute Timer for LED Lights, Street Side High

LIGHTING

- 6.24. Exterior Warning Lights are Whelen
- 6.25. (4) Whelen 900 Series Super LED Front of Body; Split Red/Blue
- 6.26. (1) Whelen 900 Series Super LED Front of Body Center Light; White
- 6.27. (4) Whelen 700 Series Super LED Grille Lights; 2 Split Red/Blue/2 White
- 6.28. (2) Whelen 700 Series Super LED Front Intersection Lights; Split Red/Blue
- 6.29. (4) Whelen 700 Series Super LED Additional Intersection Lights; 2-Amber Above Rear Wheel Wells/To Work With Turn Signals & 2-Blue on M1 & M7 Doors
- 6.30. (4) Whelen 900 Series Super LED Upper Outer Sides; 2-each side; Split Red/Blue
- 6.31. (2) Whelen 900 Series Super LED Rear Upper Outer; Red over Blue Alternating
- 6.32. (1) Whelen 600 Series Super LED Rear Center; Amber
- 6.33. (2) Whelen 900 Series Super LED Rear Window Area; Split Red/Blue
- 6.34. All Warning and Scene Lights to have Whelen Protective Flanges
- 6.35. All Warning Lights to have Clear Lenses
- 6.36. All Warning Lights to be Super Programmable
- 6.37. Brake Override for Rear 900 LED Mid-height Warning Lights

ADDITIONAL ELECTRICAL

- 6.40. Whelen WS 295HFSC9 dual tone siren; Installed in Cab Console Federal Speakers, Located Through Bumper
- 6.41. Automatic Resetting Back-up Alarm
- 6.42. Sequencer with Load Manager with By-Pass Switch
- 6.43. Vanner 1000 watt Inverter with 50 amp Battery Charger

- 6.44. Inverter Prewire Locations Cab Console & Cabinet above the Action Area (this wire through the shore line)
- 6.45. Portable Equipment Power Source Needs to be Ignition or Shoreline HOT
- 6.46. (2) Battery System, Located in the Battery Drawer Passenger Side Front
- 6.47. 30 Amp, 110 – 125 Volt Shoreline System, Twistloc, With Spring Loaded Cover Assembly
- 6.48. Engine Block Heater wired to Shoreline
- 6.49. 110 VAC Duplex Outlet; 1-Action Area, 1-Right Front ALS Cabinet, & Curbside just above the Squad Bench Lid
- 6.50. (4) 12 VDC Cigar Style Outlets, 2-Action Area, 1- Right Front ALS Cabinet, 1-Cabinet above the Action Area (This needs to be through the portable charging circuit)
- 6.51. (2) 12 VDC 30 Amp Power Sources for radios
 - (4) Coax Cables
 - (2) Radio Cable Conduits 1/5" Diameter w/ pull cable. Two pre-wire antenna coaxial cables delivered to the drivers switch console. There shall be a raceway provided to be able to run radio cable from the cab to the patient compartment.
 - Radio power #1: 30A, positive/negative, 10 awg wires with battery switch hot. Location behind passenger's seat. Radio power #2: 30A, positive/negative, 10 awg wires with battery switch hot. Location behind action area board. Coaxial cable, #1: Type RG-58U, origination point: Roof port #1 located 36" back from the front edge of the module roof and centered side to side. Access thru center upholstery panel, termination point behind passenger's seat w/36" tail.
 - Coaxial cable, #2: Type RG-58U, origination point: Roof port #2 located on the center module roof and centered side to side. Access thru center upholstery panel, termination point behind action area box w/36" tail. Conduit #1: 1.5" with pull wire, conduit origination point: Electrical circuit board cabinet, termination point behind driver's seat.
 - 2 stereo speakers in patient compartment in center pad with volume control in A/A, rear speakers in ceiling liner.
- 6.52. Exhaust Vent with both Powered Intake and Exhaust Blower Motors rated at 230 CFM each

DOES YOUR PROPOSAL COMPLY WITH ALL SECTIONS EXACTLY? YES_____NO_____

PATIENT COMPARTMENT

INTERIOR INSULATION

- 7.7. R-14 Reflectix Insulation in Roof, Wall, Doors, and Floor
- 7.8. R-10 Blue Block Insulation in Roof, Wall, Doors, and Floor between frame members

INTERIOR

- 7.9. ¾” Plywood Cabinets with High Impact Plastic Laminate on all Exposed Wood
- 7.10. Cabinet Joints to be Glued, Screwed, and Stapled
- 7.11. Plastic Laminate to be Applied with Mechanical Pinch Rollers where possible
- 7.12. Laminate to be Gloss Fashion Gray
- 7.13. Polycarbonate (Lexan) Smoked Gray
- 7.14. Cabinets to be Bolted to Minimum ½” Tapping Plates that are Welded to Module Frame
- 7.15. Cabinet Door Openings to have 3/16” Lexan Sliders Set in Heavy-Duty Black; Felt Tracks on all Four Sides; Picture Frames Lexan Housing to have Corner Keys with Set Screws; Lexan Frames to be Screwed into place

CABINET LOCATION AND APPROXIMATE DIMENSIONS:

- 7.16. Street side Rear Upper—13 ½” High x 16” Wide x 17” Deep, w/ Sliding Lexan Doors
- 7.17. Street side Rear above Telem. Area – 9 ¼” High x 22” Wide x 16” Deep w/ Flip up Lexan Door, and a Brushed Aluminum “C” Handle
- 7.18. Street side Upper above Action Area – 13 ½” High x 36” Wide x 14 ½” Deep Sliding Lexan Doors, Vertical Center Wood Divider
- 7.19. Street side Lower above Action Area- 10” High x 35” Wide x 17” Deep, Sliding Lexan Door Vertical Center Wood Divider
- 7.20. Street side Forward Upper – 13 ½” High x 11” Wide x 17” Deep, Wood Door Hinged Right with Black Locking Lever Latch, This door will also House a CompX eLock (CompX eLock will be provided by MCAD)
- 7.21. Street side Lower at Rear – 11 ¾” High x 22 ½” Wide x 17” Deep, Sliding Lexan

- 7.22. Street side Under Action Area—11” High x 16” Wide, Aluminum Access Panel Cover with Black Lever Latch, Inverter, Suction Pump, etc. Storage
- 7.23. Street side O2 Access Window—10” High x 16” Wide, with Sliding Lexan Door
- 7.24. Front Action Area – 16” High x 29” Wide x 13” Deep with ¾” Lip
- 7.25. Rear Telemetry Area – 17” High x 19 ¼” Wide x 17” Deep with ¾” Lip
- 7.26. Front Bulkhead Cabinet over Walk-Through – Electrical Cabinet, Hinged at the Bottom, With a Black Lever Latch
- 7.27. Right Front Int. / Ext. Cabinet – 45” High x 20 ¾” Wide x 20” Deep, No Doors, 3 Adjustable Shelves at ½” Increments
- 7.28. Single Squad Bench Lid, Storage 8 ½” High x 40” Wide x 14” Deep
- 7.29. Curbside Foot of Squad Bench, 3 Glove Storage and Sharps and Trash Storage, Glove Storage to have a Lexan Door w/ Oval Cut Outs Hinges Left, Sharps and Trash will be Tilt Out with Access Ports for each. Sharps will be Located above the Trash. Curbside Rear Upper
- 7.30. CPR Seat 24” Wide, with 4” Rounded Padded Arm Rest
- 7.31. HVAC System to be located above Right Front Int. / Ext. Cabinet, Intake will be located on the side of the Right Front Cabinet in the Walk Thru

PATIENT COMPARTMENT RESTRAINTS

- 7.32. Squad Bench (2) 6- Point Restraint System, Mounted through 1/2” Thick Side Impact Rails
- 7.33. Squad Bench Secondary Patient Restraints (3) To Run From Curbside Wall To Face of S/B
- 7.34. CPR Side Seat (1) 2-Point Restraint System, Mounted through ½” Thick Side Impact Rails

MISCELLANEOUS PATIENT COMPARTMENT INTERIOR/UPHOLSTERY

- 7.35. Curbside Foot of Squad Bench Cabinet with (3) Glove Box Dispenser, Recessed into the Wall at the Foot of the Squad Bench above the Sharps & Trash
- 7.36. Bio-Waste Disposal at Foot of Squad Bench; 6-Quart Trash & 3-Qt. Bemis Sharps, Recessed into Wall at the Foot of the Squad Bench

- 7.37. Aircraft Rated Crash Net at Head of Squad Bench
- 7.38. Individual Removable Back Rest and Head Rest to be provided on Squad Bench Back Wall
- 7.39. Removable Back Rest for CPR side Seat
- 7.40. Right Front ALS Cabinet to have Unistrut Style Adjustable Shelf Tracks w/ 3-Shelves
- 7.41. Single Sheet 3/4" 7-Ply Exterior Marine Grade Plywood Floor
- 7.42. Dark Gray Optima Seamless Vinyl Flooring Rolled-up Wall 3" and Recessed into Cabinet 1/2 "
- 7.43. Vacuum Formed (Seamless) Captain's Chair With Arm Rest Left and Right
- 7.44. 32 Oz. Vacuum Formed Seamless Upholstery; Color to be Blue
- 7.45. Seat Base Mica Covered Metal, w/ Cabinet Door Hinged at the Bottom, Non Locking Latch

MISCELLANEOUS EQUIPMENT/GRABRAILS

- 7.46. Three (3) Oxygen Outlets; 2-Action Area & 1- Over Head of Squad Bench
- 7.47. (2) Cast Products KKK-E Recessed Fold-Down IV Hooks
- 7.48. SSCOR Suction Unit with Bemis Canister and Thomas Suction Pump, Canister Recessed into Curbside Action Area Wall
- 7.49. Smith Works IV Warmer 12CDC, Floor Mount, Located in Street Side Upper above A/A
- 7.50. Hand-Cap Style Entry Door Grab Handles, Gray and Antimicrobial Coated
- 7.51. Curbside Recessed Grab Rail 1.25" Diameter, 3 Point, 72 Inch, Gray Antimicrobial Coated
- 7.52. Stryker #6370 Cot Mount Setup, Located Center Position, Must Maintain 12" between Cot and S/B Stryker Cot Stop Block

DOES YOUR PROPOSAL COMPLY WITH ALL SECTIONS EXACTLY? YES_____NO_____

8.1. PAINT/FINISHING

- 8.2. Two-Stage Basecoat Clearcoat Paint with all Hardware and Doors removed from Body
- 8.3. Solid Frost White Cab and Body
- 8.4. Paint to be applied with Electrostatic Process
- 8.5. Minimum 7 year or 70,000 mile Paint Warranty
- 8.6. Custom Silver and Maroon Paint Stripes which include Dual Inter-Locking “Z” Patterns to match current paint scheme.
- 8.7. ½” Maroon Reflective Pin Stripes to Border Silver Stripes
- 8.8. ¼” Ultra Metallic Silver to Board Maroon Stripes
- 8.9. 4” White Reflective Stripe to Separate Skirtline Silver Stripe from Lower Maroon Stripe
- 8.10. Red and White Reflective Tape on (3-M Diamond Cut) across Rear Step
- 8.11. White Reflective Tape Located on Top and Side of All Doors Frame Returns

LETTERING

- 8.12. Custom Lettering to be Reflective Maroon with Ultra Metallic Silver Border
- 8.13. Sides: 6” “MILLER COUNTY” – in arch
“16” Star of Life” – maroon and silver
“AMBULANCE DISTRICT” – straightline
- 8.14. Rear: 4” “MILLER COUNTY” - straightline on doors below windows
“AMBULANCE DISTRICT” - straight-line
- 8.15. DOT Lettering Package to be installed
- 8.16. Roof “Star of Life” Installed

DOES YOUR PROPOSAL COMPLY WITH ALL SECTIONS EXACTLY? YES_____NO_____

9. OPTIONAL EQUIPMENT/PROPOSAL INFORMATION:

In addition to the specifications required and set forth in the previous section, Miller County Ambulance District will consider the following options in addition to the base unit. Each option should include: 1) price inclusive of all installation charges and stated separately and in addition to the base unit price proposed where applicable, 2) make/manufacture, 3) warranty information stated separately. Final determination of which/if any options will be chosen will be at the sole discretion of the Board of Directors and/or their agents.

Option 1: 4 Camera System: Mobile Witness Recorder w/ GPS, Engine Computer Cable Hookup, and (3) Recording Cameras:

- (1) Patient Compartment Bullet Camera, (1) Cab Forward Mounted Camera (Facing the Road), and (1) Camera Facing Cab Instrument Panel. External recording drive to be mounted in secure location to prevent unauthorized access.
- Non-Recording Backup Camera with 7" ASA Monitor Located in Cab in ABS Housing with backup and patient compartment viewing.

Option Price \$_____

Option 2/Snow Chains: On Spot Electric Snow Chains, With Air Tank Located Between the Frame Rails

Option Price \$_____

Option 3/Valve Stem Extensions: Cat Eye System or similar to be installed on rear dual wheels. The valve stem extensions are to be steel braided lines that are held in place with stainless steel brackets. These brackets are to be located in such a way as to provide easy access to both the inside and outside rear tires valve stems for the checking of tire pressure and for the addition of air when required.

Option Price \$_____

Option 4/Child Restraint Seat: Child restraint seat to be incorporated into captains' seat with 3 point safety harness.

Option Price \$_____

Option 5/Air Horn: Air horn system with an electric air compressor, air reserve tank and (2) bumper mounted trumpets. The air horns are to be activated by a momentary style switch in the front control console when the master emergency switch is in the on position.

Option Price \$_____

CONCEPTIONAL DRAWINGS ONLY: DRAWINGS ARE NOT TO SCALE, ALL MEASURES ARE APPROXIMATE & SUBJECT TO ENGINEERING CHANGE

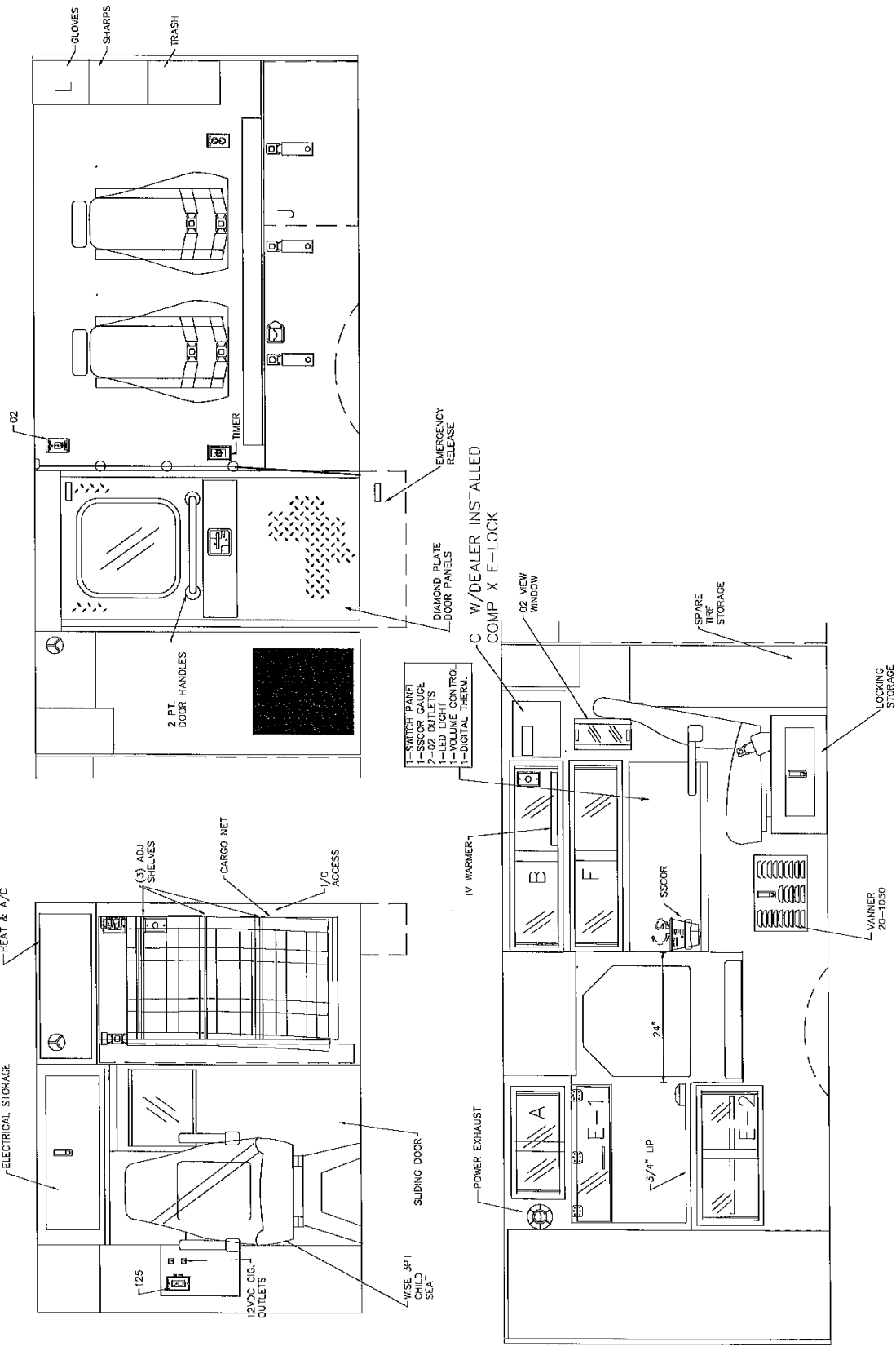

*CONCEPTIONAL DRAWINGS
 * Some shown are optional
 * Due to AEV's ongoing improvements, drawings can change.