

MILLER COUNTY AMBULANCE DISTRICT TYPE III AMBULANCE REMOUNT(S)

Request for Proposals: Type III Ambulance Remount(s)
Closing Date: April 7th, 2016



P.O. Box 227, Eldon, MO 65026
Email: kjohnson@millercountyambulance.org

SPECIFICATIONS

FOR

Remounts of Type III Ambulance(s)

FOR ADDITIONAL INFORMATION CONTACT:

Kevin Johnson, District Administrator
573-392-7303
kjohnson@millercountyambulance.org

Closing Date/Time: April 7th, 2016 at 9:00 A.M. Local Time

MANUFACTURER'S COMPANY
NAME _____

REPRESENTATIVE _____

TELEPHONE
NUMBER _____

E-MAIL
ADDRESS _____

1. INTRODUCTION AND GENERAL INFORMATION

This document constitutes a Request for Proposals, (RFP), for the remounting and refurbishment of One (1) or Two (2) Type III ambulances, the final number to be determined based upon evaluation of the cost of the project; budget resources and the needs of the District. **The amount of time that the ambulance will be out of service is of the utmost importance to Miller County Ambulance District and will have a substantial bearing upon the award of this proposal. Timing of the delivery of the remounts is anticipated as follows:**

1. First remount is to be scheduled upon award of this Request for Proposal with a desired delivery date back to the District as soon thereafter as feasible.
2. Second remount will be scheduled after delivery of the first remount and satisfaction by the District of the manufacturers successful completion of the first remount and within a mutually agreeable date and time/frame.

A. Organization – This document, referred to as a Request for Proposal, (RFP), is divided into the following parts:

1. Introduction and General Information
2. Signature Affidavit
3. Specifications/General
4. Request for Proposal Submission Information
5. Pricing page(s)
6. Terms and Conditions
7. Signature
8. Section II/Detailed Specifications
9. Optional Features

Proposal Specifications:

- B. Although an attempt has been made to provide accurate and up-to-date information, Miller County Ambulance District does not warrant or represent that the background information provided herein reflects all existing conditions related to this Request for Proposal.
- C. All manufacturers are to include in their proposal any and all costs associated with this project including but not limited to materials, equipment, freight, delivery, dealer preparation and set-up, and labor.
- D. Title: All equipment shall remain the property of the seller until delivered to and accepted by the District. Equipment supplied by the District shall remain the property of the District.
- E. Following this section is a “SIGNATURE AFFIDAVIT” form. In order to be considered for this RFP, you must fill out this form and include it with your submission.

Miller County Ambulance District is accepting Requests for Proposals for the remounting and refurbishment of One (1) or Two (2) Type III ambulance vehicles based on the enclosed specifications.

The deadline for proposals is April 7th, 2016 at 9:00 a.m.

All proposal documents shall be submitted to:

**Miller County Ambulance District
Attention: Kevin Johnson, Administrator
P.O. Box 227
Eldon, MO 65026**

Street Address:

1304 South Aurora, Eldon, MO 65026

The signature affidavit on page 5 of this document must be completed and signed in order for the proposal to be accepted.

The Miller County Ambulance District reserves the right to reject any or all proposals when deemed to be in the best interest of the District.

Questions may be directed to:

Kevin Johnson, Administrator
P.O. Box 227
Eldon, MO 65026
573-392-7303
Email: kjohnson@millercountyambulance.org

2. SIGNATURE AFFIDAVIT

By submitting this proposal, we certify that the following:

- We have not directly or indirectly entered into any agreement or participated in any collusion or otherwise taken any action in restraint of free competition.
- No attempt has been made to induce any other person or firm to submit or not to submit a proposal.
- This proposal has been independently arrived at without collusion with any other competitor or potential competitor.
- This proposal has not been knowingly disclosed prior to the opening of proposals to any other manufacturer or competitor.
- Under the penalty of perjury, the above statements are accurate.

The undersigned, submitting this proposal, hereby agrees with all the terms, conditions and specifications required by the Miller County Ambulance District in this RFP, and declares that the attached proposal and pricing are in conformity therewith.

Name (Type or Print)	Title	
Signature	Company or Firm	
Address		
City	State	Zip
Telephone	Fax	
E-Mail		

3. SPECIFICATIONS

- A. Unless otherwise specified, all components utilized in the remount proposed shall be new, current manufacturer model year in undamaged condition, with the refurbished unit(s) delivered to the Miller County Ambulance District, 1304 South Aurora, Eldon, MO 65026 and shall meet the following minimum specifications:

See Section II for Specification Details

- B. A complete set of specifications of the units including; drawings/measurements of the front, rear, streetside, curbside, and interior, descriptive literature, date of delivery and warranty information (including copies of the actual warranties and disclaimer to be issued) shall be included with the RFP submittal. All deviations or variances from the above specifications shall be expressly identified and explained. Any exception, clarification, or variation from these specifications shall be clearly indicated. Any exception, clarification, or variation must be described in writing with enough detail to enable Miller County Ambulance District to make an accurate evaluation of the impact to the ambulance. If no exception, clarification, or variation is noted, it shall be understood that the delivered ambulance shall be in strict compliance with our specifications. Miller County Ambulance District shall be the sole judge of equality and our decision shall be final. Failure to provide this information may result in a proposal not being considered.

C. DESCRIPTION OF AMBULANCES FOR REMOUNT

The following ambulances are being considered by the District for remounting and refurbishment. Ambulances have mileage ranging of 215,000 to 250,000 miles at the time of drafting of this proposal. **It is the intent of Miller County Ambulance District to standardize its fleet, and in doing so, utilize a similar layout and design of all ambulances purchased after 2010. Both 2009 ambulances will require modification of the cabinet configuration, addition of a CPR seat and relocation of the Stryker Cot mount from a left to center mount position to modify the interior of the module to as closely resemble the current layout as feasible.** Ambulances may be examined at the District headquarters, during regular business hours. Arrangements should be made, in advance, to inspect the equipment by contacting Kevin Johnson, Administrator at 573-392-7303.

Year/Make	Type	Quantity Owned
2009 GM-3500/AEV Traumahawk	Type III	2
2010 GM-3500/AEV Traumahawk	Type III	2

4. REQUEST FOR PROPOSAL SUBMISSION INFORMATION

The District welcomes all interested parties to participate in its Request for Proposal process. Manufacturers will be expected to submit a proposal that is in compliance with the terms and conditions as outlined below:

- A. All awards are subject to final approval by the Board of Directors of Miller County Ambulance District, or their designated representatives(s).

- B. Proposal must be delivered to District Headquarters on or before the time and date stipulated in the Request for Proposal document. All late proposals will be rejected.
- C. Vendors may submit more than one proposal. No penalty or credit will be given for submitting multiple proposals.
- D. Manufacturers are responsible for reviewing their proposals prior to submission to be certain they can honor all price, terms and conditions offered in the proposal. Manufacturers may submit written amendments or withdraw their proposals up until the date and time of the scheduled RFP closing. Once proposals have been opened, all manufacturers will be expected to honor all prices and terms offered in total. Unit price will prevail in cases of extension errors. Proposal default will result in either temporary or permanent removal from the District's list of vendors in good standing.
- E. State of Missouri Sales Taxes are not applicable to sales made to Miller County Ambulance District and must be excluded.
- F. Please note that this request for proposals is being published and sent directly to a number of vendors. The District reserves the right to select the proposal determined to be the most advantageous to the District at its sole discretion. The selection process will be factored around acquisition costs, however, lowest cost is not the only factor that will be considered by the District. Miller County Ambulance District and its agents reserve the right to reject any or all proposals when deemed in the best interest of the District, purchase from any or all vendors, request additional information and to negotiate on behalf of the District.
- G. Qualifications of Manufacturer: Each manufacturer must submit with the proposal written evidence of qualifications to furnish the equipment and a list of previous customers of the type of units, equipment, or services bid. Manufacturers may be required to submit evidence that they have adequate financial and technical ability to furnish and service the equipment, maintain spare parts for maintenance and repair of the equipment, and have an acceptable service record on equipment previously supplied to others.
- H. A complete set of specifications of the units, descriptive literature, date of delivery and warranty information (including copies of the actual warranties and disclaimer to be issued) shall be included with the RFP submittal. **All deviations or variances from the above specifications shall be expressly identified and explained. Failure to provide this information may result in a proposal not being considered.**
- I. All questions about the meaning or intent of the Contract Documents or requirements are to be submitted in writing to the District Office not less than 14 days prior to the date of RFP opening.
- J. **Withdrawal of Proposal:** Proposals may be withdrawn by notice in writing only if received by the District prior to RFP opening. After RFP opening, proposals may not be withdrawn and shall remain open for 90 days after RFP opening.
- K. Request for Proposal Closes:

Proposals must be submitted by **9:00 A.M. local time on April 7th, 2016**. Only original proposals will be accepted. No copies or facsimile transmissions will be accepted. **All proposal documents shall be submitted to:**

**Miller County Ambulance District
Attention: Kevin Johnson, Administrator
P.O. Box 227
Eldon, MO 65026**

**Street Address:
1304 South Aurora, Eldon, MO 65026**

PROPOSALS RECEIVED AFTER THIS DATE AND TIME WILL NOT BE CONSIDERED.

- L. Offer: All proposals offered shall be firm for a minimum of ninety (90) calendar days after RFP closing date.
- M. Determination: Miller County Ambulance District reserves the right to be the sole determining party as to which proposal meet specifications. Any item, which, in the opinion of the management of the District, does not produce satisfactory results or services, may be returned to the successful manufacturer as not meeting specifications.
- N. Inquiries: All inquiries should be directed to:

Kevin Johnson, Administrator
Miller County Ambulance District
P.O. Box 227
Eldon, MO 65026
573-392-7303
Email: kjohnson@millercountyambulance.org
- O. Signature: All proposals must be signed by a duly authorized representative of the person, partnership or corporation offering the proposal. Failure to sign the Request for Proposal document will result in automatic disqualification of that proposal. The District reserves the right to request written confirmations of persons authorized to sign all proposals on behalf of a company.

OPTION #1: 2009 MODEL REMOUNTS

5. PRICING—REMOUNTING OF 2009 MODEL AMBULANCES

I, (We), the undersigned after reading and fully understanding the terms, conditions and specifications of this Request for Proposal, submit the following proposal and agree to furnish a firm and fixed price as follows:

CHASSIS MAKE/YEAR: _____

Based on the information and specifications given, proposals are to indicate pricing for one (1) and two (2) 2009 remounted units:

\$ _____ DELIVERED PRICE EACH FOR ONE (1) 2009 REMOUNTED UNIT

\$ _____ DELIVERED PRICE EACH FOR TWO (2) 2009 REMOUNTED UNITS

First Ambulance:

Date ambulance is to be delivered to remounting manufacturer: _____

Date completed ambulance will be delivered back to District: _____

Second Ambulance:

Date ambulance is to be delivered to remounting manufacturer: _____

Date completed ambulance will be delivered back to District: _____

List any other additional costs associated with this project:

PROPOSAL IS: ____ As per specification, taking no exceptions

____ Taking only the specification exceptions noted on the “EXCEPTION ATTACHMENT”

ALL REQUIRED ATTACHMENTS OF THE PROPOSAL ARE INCLUDED: ____ Yes ____ No

ATTACHMENT FOR OPTIONAL EQUIPMENT IS INCLUDED: ____ Yes ____ No

OPTION #2: 2010 MODEL REMOUNTS

5. PRICING—REMOUNTING OF 2010 MODEL AMBULANCES

I, (We), the undersigned after reading and fully understanding the terms, conditions and specifications of this Request for Proposal, submit the following proposal and agree to furnish a firm and fixed price as follows:

CHASSIS MAKE/YEAR: _____

Based on the information and specifications given, proposals are to indicate pricing for one (1) and two (2) 2010 remounted units:

\$ _____ DELIVERED PRICE EACH FOR ONE (1) 2010 REMOUNTED UNIT

\$ _____ DELIVERED PRICE EACH FOR TWO (2) 2010 REMOUNTED UNITS

First Ambulance:

Date ambulance is to be delivered to remounting manufacturer: _____

Date completed ambulance will be delivered back to District: _____

Second Ambulance:

Date ambulance is to be delivered to remounting manufacturer: _____

Date completed ambulance will be delivered back to District: _____

List any other additional costs associated with this project:

PROPOSAL IS: ____As per specification, taking no exceptions

____Taking only the specification exceptions noted on the “EXCEPTION ATTACHMENT”

ALL REQUIRED ATTACHMENTS OF THE PROPOSAL ARE INCLUDED: ____Yes ____No

ATTACHMENT FOR OPTIONAL EQUIPMENT IS INCLUDED: ____Yes ____No

OPTION #3: (1) ONE 2009 AND (1) ONE 2010 MODEL REMOUNTS

5. PRICING—REMOUNTING OF (1) ONE 2009 AND (1) ONE 2010 MODEL AMBULANCES

I, (We), the undersigned after reading and fully understanding the terms, conditions and specifications of this Request for Proposal, submit the following proposal and agree to furnish a firm and fixed price as follows:

CHASSIS MAKE/YEAR: _____

Based on the information and specifications given, proposals are to indicate pricing for one (1) 2009 and one (1) 2010 remounted units:

\$ _____ DELIVERED PRICE EACH FOR ONE (1) 2009 REMOUNTED UNIT

\$ _____ DELIVERED PRICE EACH FOR ONE (1) 2010 REMOUNTED UNITS

First Ambulance:

Date ambulance is to be delivered to remounting manufacturer: _____

Date completed ambulance will be delivered back to District: _____

Second Ambulance:

Date ambulance is to be delivered to remounting manufacturer: _____

Date completed ambulance will be delivered back to District: _____

List any other additional costs associated with this project:

PROPOSAL IS: ____As per specification, taking no exceptions

____Taking only the specification exceptions noted on the “EXCEPTION ATTACHMENT”

ALL REQUIRED ATTACHMENTS OF THE PROPOSAL ARE INCLUDED: ____Yes____No

ATTACHMENT FOR OPTIONAL EQUIPMENT IS INCLUDED: ____Yes____No

6. TERMS AND CONDITIONS

A. Contract Terms: The performance of this Contract shall be governed solely by the terms and conditions set forth in the Contract notwithstanding any language contained in any invoice, shipping order, bill of lading or other document furnished by the Seller at any time. The Acceptance by the District of any goods furnished hereunder accompanied by any such document shall not be construed as an acceptance by the District of any terms or conditions contained in such document which are inconsistent with the terms and conditions set forth in this Contract. Any different or additional terms, other than those contained in the Contract, which are contained in any acceptance, acknowledgment, invoice or other document transmitted by Seller to the District are hereby objected to.

B. Compliance with Specifications: No payment will be rendered for items delivered that fail to meet specifications as offered in proposal and all items delivered below specifications must be completely corrected or award will be forfeited to another manufacturer meeting the specifications.

C. Sellers Warranties: Seller expressly warrants that all articles, material and work covered by this contract will conform to each and every specification, drawing, sample or other description, which is furnished to or is adopted by the District and that they will be fit and sufficient for the purpose intended, merchantable, of good material and workmanship and free from defect. Such warranty shall survive delivery and shall not be deemed waived either by reason of the District’s acceptance of said material or goods, or by payment for them.

D. Bankruptcy or Insolvency: In the event of any proceedings by or against either party, voluntary or involuntary, in bankruptcy or insolvency, or for the appointment of a receiver or trustee or an assignee for the benefit of creditors, of the property of Seller, the District may cancel this Contract or affirm the Contract and hold Seller responsible in damages.

E. Other: All proposals received by the RFP closing date and time will be considered, however, the District reserves the right to reject any and all proposals and to waive any informalities in the RFP process. All pages of this proposal are to be returned with the signature page filled out and signed. Failure to do so could result in disqualification of proposal.

7. SIGNATURE PAGE

I have read and understand this invitation for Request for Proposal and certify that I am a duly authorized representative of the person, partnership, or corporation offering this proposal:

Company Name: _____

Address: _____

City/State/Zip Code: _____

Federal Tax ID (EIN): _____

Telephone Number: _____

Email Contact: _____

Name/Title of Person Signing: _____

Signature: _____ Date Signed: _____

8. SECTION II/RFP DETAILED SPECIFICATIONS

1. Scope, Purpose and Classification

- A. **Scope:** This specification covers the remounting and refurbishing of one (1) or two (2) commercially produced, ground emergency medical vehicle, hereinafter referred to as ambulance or vehicle. This vehicle shall be in accordance with the Ambulance Design Criteria of the National Highway Traffic Administration, U.S. Department of Transportation, Washington D.C. This unit shall be verified and certified that it maintains KKK-A1822 revision at the time of original manufacture. The manufacturer must point out any discrepancies in this specification that may violate any FMVSS or state government licensing requirements. Failure of a vehicle to be certified due to omission or violation of these requirements will be the liability of the vendor.
- B. **Purpose:** The purpose of this document is to provide the manufacturer with minimum specifications and test parameters that will meet the criteria for the remounting and refurbishment of an emergency medical care vehicle as set forth by this agency. It establishes essential criteria for the design, performance, equipment and appearance of the vehicle. It is the intent of this document to return the ambulance to a new or like new condition per these specifications. This agency seeks a vehicle that will deliver “fair value”. Fair value is defined by this agency as the manufacturer’s ability to provide a safe, functional, and practical solution to the remounting process that will work in conjunction with the chassis specified at a reasonable cost. The specifications within this document are a basis to deliver such a vehicle to this agency. This agency at its discretion shall assess the intangible assets of the manufacturer such as, but not limited to; after quality, delivery support, customer service, parts availability, warranty, remounting capabilities, and turn-around time. The objective of this document is to provide a vehicle that is in accordance with nationally recognized guidelines.
- C. **Classification:** This specification call for the following type vehicle.
Type III – Integral Cab Chassis with modular ambulance body
Dual rear wheel driven
ALS elevating cot and squad bench

2. Requirements

- A. **General:** This is an engineer, design, construct, and delivery type specification and is not the intention of this agency to write out vendors of similar or equal equipment of the types specified. It should be noted, however, that this specification is written around specific needs of this agency with the intent to standardize certain components. Therefore, in numerous places we have named specific brands of components. This has been done to establish a certain standard of quality. Other brands will only be accepted providing the vendor provides documentation in the proposal that the particular brand offered meets or exceeds the quality of the actual brand called for in the specification.
- B. **Materials:** The ambulance, chassis, ambulance body, equipment, devices, medical accessories, and electronic equipment to be delivered under this contract shall be standard commercial product, which meet or exceed the requirements of this specification. The ambulance shall comply with all Federal Motor Vehicle Safety Standards (FMVSS), the Federal regulations applicable or specified for the year of manufacture. The chassis, components and optional items shall be as represented in the manufacturer’s current technical data. Materials used in the construction shall be new and not less than the quality conforming to current engineering and manufacturing practices. Materials shall be free of defects and suitable for service intended.
- C. **Quality Control:** Before any work is started, a complete set of exterior and interior photos shall be taken at the remount facility. These photos shall be used for reference during the remounting process and confirmation upon delivery and inspection. Photos will be emailed to the purchaser prior to any work being started. A signoff document will follow the

remount. Each station will sign-off throughout the remount process. This document must be available for review by the purchaser at the time of delivery. A copy of this document shall be included with your bid.

- D. Manufacturing Ability: It is the intent of these specifications that the manufacturer of this vehicle has the ability to remount and refurbish a complete ambulance within their plant or facility, except the chassis. The ambulance manufacturer must have significant experience in the remounting and refurbishment of modular ambulance bodies. The location of remounting facilities should be within reasonable proximity to the District and clearly identified within the proposal.
- E. Service/Repair: Manufacturer shall have service facilities to service the units and/or provide warranty work within reasonable proximity to the District. The location of these facilities shall be clearly identified within the proposal. Additionally, the manufacturer should also specify the availability of a loaner units in these events.
- F. References: As further evidence of the manufacturer's ability to fulfill its obligations, the manufacturer contractor shall submit a list of customers with similar type ambulance conversion units. The references shall also include name of service, address, contact, and phone number.
- G. Exceptions to Specifications: Any exceptions to these specifications indicated must be clearly identified and noted on the "Exceptions Attachment." Otherwise, it will be considered that items offered are in strict compliance with these specifications and the successful manufacturer will be held responsible for delivering a vehicle meeting these specifications. Any exception must reference by item number and be explained with enough detail to determine the impact upon the ambulance delivered.

3. Price, Warranty, Payment and Delivery Date:

- A. All proposal prices shall be complete and include warranty and delivery of the completed vehicle.
- B. Payment shall be made in accordance with these specifications and the proposal submitted by the manufacturer. Payment will be made upon acceptance of the vehicle and equipment specified under these specifications.
- C. All proposal price and conditions must be specified on the Request for Proposal Form. Proposal prices shall be valid for at least 90 days from the date of RFP opening, or as otherwise specified on the Request for Proposal Form.
- D. Full payment will be made when unit is received, inspected and found to comply with procurement specifications, free of damage and properly invoiced.
- E. A penalty of One hundred dollars (\$100.00) per day shall be assessed against manufacturer for each day past completion date that work is not completed.
- F. The successful manufacturer shall provide a manufacturer's warranty coverage for the ambulance remount, which shall at a minimum include:
- G. Existing Warranties: It is the intent of Miller County Ambulance District to maintain any existing warranty on the modular box offered by the original manufacturer. The successful remounting manufacturer shall ensure that any processes performed during the remounting process shall not void nor compromise any remaining warranty of the original manufacturer. It will be the responsibility of the successful remounting remanufacturer to ensure the integrity of any remaining warranty and/or assume any remaining warranty under the same terms and conditions as the original manufacturer. A copy of this warranty is to be included as part of the proposal document.

- H. A Conversion Warranty shall be provided on the ambulance remount conversion. The remounter shall warrant to the District that, for a period of 7 years or 70,000 miles, the ambulance remount shall be free of substantial defects in the remount materials and workmanship. The effective starting date will be the date the District accepts delivery of the completed vehicle. It is the intent of this requirement that items not manufactured or installed by the ambulance manufacturer be excluded. There shall be a copy of the Remount Warranty statement included as part of the proposal document.
- I. An Electrical Warranty shall be provided on the ambulance remount. The remounter shall warrant to the District that, for a period of 7 years or 70,000 miles, the ambulance remount electrical system shall be free of substantial defects in the remount materials and workmanship. The effective starting date will be the date the District accepts delivery of the completed vehicle. It is the intent of this requirement that items not manufactured or installed by the ambulance manufacturer be excluded. There shall be a copy of the Electrical Warranty statement included as part of the proposal document.
- J. A Paint/Graphics Warranty shall be provided on the ambulance remount conversion. The remounter shall warrant to the District that, for a period of 3 years or 36,000 miles, any painting or graphics processes occurring during the ambulance remount shall be free of substantial defects in materials and workmanship. The effective starting date will be the date the District accepts delivery of the completed vehicle. It is the intent of this requirement that items not manufactured or installed by the ambulance manufacturer be excluded. There shall be a copy of the Paint/Graphics Warranty statement included as part of the proposal.
- K. Warranty on the chassis portion of the completed ambulance shall be the responsibility of the chassis manufacturer. Remounting Manufacturer shall be responsible in providing reasonable assistance to the purchaser in obtaining warranty from the chassis manufacturer or its authorized service center.
- L. Insurance: All manufacturers shall have in place product liability insurance. *Copy of insurance certification to be provided with proposal.*
- M. **Delivery: Final delivery date and the time the provided ambulance(s) are out of service will be a significant factor in the evaluation process used for determination of the award of the proposals received. Delivery schedule will include: 1) the date the ambulance is to be delivered to the manufacturer and 2) the date when the final remounted ambulance will be delivered back to the District. The delivery schedules that are submitted by the manufacturer and agreed upon by the District shall automatically become binding upon the successful manufacturer. Manufacturer shall provide in writing to accompany this document a proposed delivery time. The delivery time proposal will include the transit time of the finished vehicle.**

4. TECHNICAL REQUIREMENTS – CHASSIS

Listed below are minimum technical specifications for the removal of Miller County Ambulance District’s Type III Ambulance Module and subsequent remount to a 2015 or newer General Motors G3500 Cutaway Chassis. Vehicle must comply with Federal and State laws and regulations and all safety regulations as applicable on date of delivery concerning automotive equipment and conditions and will be complete with standard equipment and all extra equipment as specified. The chassis manufacturer shall be the vehicle’s point of origin. A statement of conformity shall be supplied with the chassis in an “Incomplete Vehicle Manual.”

Chassis disposal shall be the responsibility of the remounting manufacturer.

Manufacturer and Model Year: The chassis requirement for this specification is a

2015 General Motors G3500 or Newer/Cutaway Van Cab, Dual Rear Wheel, 2 Wheel Drive Chassis, YF2 Ambulance Prep Package and equipped as follows:

- 4.1.** Highest Trim Level available from the OEM. Package shall include high quality chrome bright work on the grille face. Chrome plated steel bumpers shall also be supplied by the OEM.
- 4.2.** 139" Wheelbase dual rear wheel.
- 4.3.** Duramax 6600 Turbo-Diesel engine
- 4.4.** SCR System: There shall be an Emission Compliant system consisting of a 5.83 gallon, Diesel Exhaust Fluid (DEF) tank. The chassis manufacturer will include warning systems when the fluid gets low and then the chassis system will start to shut down and finally limit the chassis to 5mph when the system is empty. On the 139" wheelbase chassis with a mid-ship fuel tank, the SCR tank shall be located behind the rear axle.
- 4.5.** 12,300 lbs. G.V.W.R.
- 4.6.** Dual 145 Amp Alternators.
- 4.7.** Batteries: The ambulance conversion and chassis shall run with three (3) 750 Amp/maintenance free 12 volt batteries; 1-Under Hood & 2- in Exterior Compartment Battery Drawer. Batteries shall be wired in parallel to maximize starting amperage. The batteries shall be wired to work together simultaneously per Ford QVM bulletin number 63.
- 4.8.** Engine Block Heater/Part of YF2 Package. Heater shall be wired to the 125-volt shoreline input on the modular body. There shall be an in-line switch provided behind the driver's seat to provide turn off capability for the block heater during hot weather. This switch shall be clearly labeled.
- 4.9.** A 6-Speed Automatic, Heavy Duty, Electronically Controlled with overdrive, tow/haul mode and internal transmission oil cooler.
- 4.10.** Auxiliary Transmission Oil Cooler: The primary transmission fluid cooler shall be built into the engine's radiator. The hot fluid shall exchange heat into cooling tubes within the radiator and then flow through auxiliary automatic transmission oil cooler that is located directly behind the grille. This cooler shall be set in front of the air conditioning condenser and the engine radiator. This auxiliary cooler shall feature three-eighth inch diameter cooling tubes with a minimum of twenty heat transfer plates.
- 4.11.** Rear Wheel Drive/Locking Differential/3.73 Axle Ratio.
- 4.12.** Front Axle Weight Rating no less than 4,600 pounds/Rear Axle Weight Rating of no less than 8,600 pounds.
- 4.13.** 31 Gallon Fuel Tank.
- 4.14.** Stainless Steel Exhaust. Shall be on the driver's die exit rearward of the rear dual wheels on the chassis to be cut back to the body sidewall.
- 4.15.** Power-assisted recirculating ball steering.
- 4.16.** 4-wheel disc brakes with front vented discs.
- 4.17.** Independent front suspension.

- 4.18.** Front coil springs with front stabilizer bar.
- 4.19.** HD front/rear shocks.
- 4.20.** Rigid rear axle.
- 4.21.** Rear leaf spring suspension.
- 4.22.** Front and rear 16.0" x 6.0" silver steel wheels.
- 4.23.** LT225/75R16.0E BSW front and rear tires with STEEL VALVE STEMS. Matching spare will be mounted/balanced and shipped loose with the completed vehicle.
- 4.24.** 4-wheel anti-lock braking system.
- 4.25.** Dual airbags.
- 4.26.** Front height adjustable seatbelts with pretensioners.
- 4.27.** Air Conditioning
- 4.28.** AM/FM CD stereo, clock, seek, scan, fixed antenna.
- 4.29.** Cruise control Engine High-Idle Speed Control, Automatic: The vehicle shall be equipped with an OEM high idle system. The system shall be activated through the cruise control switches and only operate with the vehicle in Park/Neutral with the emergency brake deployed and shall idle down if the vehicle brake pedal is depressed.
- 4.30.** Tilt Steering Wheel
- 4.31.** Power door locks and Power Windows
- 4.32.** Analog instrument display includes oil pressure gauge, water temperature gauge, voltmeter, and trip odometer.
- 4.33.** Warning indicators include oil pressure, water temperature, battery, key in ignition, and door ajar.
- 4.34.** Intermittent windshield wipers
- 4.35.** Day-night rearview mirror.
- 4.36.** Interior lights including dome light.
- 4.37.** O.E.M. Cloth Captains seats/high back, with fixed headrests, driver and passenger armrests. Interior color to be Medium Pewter.
- 4.38.** Vinyl door trim, full cloth headliner.

- 4.39. O.E.M. Rubber Cab Flooring
- 4.40. Front license plate bracket.
- 4.41. Black door handles.
- 4.42. Chrome grille.
- 4.43. Dual Velvac Euro-style Power, Heated w/ Turn Signal Rear View Mirrors with Convex.
- 4.44. Chrome Front Bumper
- 4.45. Aero-composite halogen headlamps
- 4.46. Mud Flaps are to be installed on both front and rear wheels.
- 4.47. Diamond Tread plate Running Boards with Fender Flair and Grip Strut Inserts
- 4.48. Phoenix Stainless Steel Wheel Covers, concaved on Front and Rear to Give the Appearance of Chrome Wheels.
- 4.49. Valve Extenders for Dual Rear Wheels: Valve extenders to permit the user to check tire pressure and fill the inside rear tires without removing the outer tire. The extenders shall have a braided stainless steel outer jacket to resist abrasions and cuts.

Does Your Proposal Comply to Specifications: Yes No Deviations Noted

5. Removal and Transfer of Modular Ambulance Body

It is the intent of Miller Count Ambulance District that the remounting process, as performed by the vendor, will be to refurbish the ambulance and its components to “like new” condition. Further, it is the intent of this agency that all methods utilized in this process by the vendor comply with all applicable safety standards and guidelines in place for both the model year and that of the conversion. In all manners, the final remount shall meet or exceed any applicable standards in place for all aspects of the remounting process. The remounting vendor is to note their approach to this section and their recommended solution that deviates from the specifications or alternatively exceeds them.

5.1. Ambulance Module: This agency's existing ambulance module will be utilized.

5.2. Dismount & Inspection: Disconnect all sub systems between chassis and module. This will include all environmental connections, all electrical connections, and all structural connections. Lift the module to allow full inspection of understructure. This removal will in no way deform, disfigure, or compromise the module. The fuel system shall be properly separated from the chassis and the body. Remove the cab seats if necessary and center console to remove the harness that connects the chassis and the body. The body tail lights shall be properly disconnected from the body/chassis so they can be reconnected to the new chassis harness. The two-way radios shall be properly disconnected and removed prior to sending to the successful bidder. The purchaser's radio shop will be responsible for reinstalling and reconnecting the systems after delivery. The successful bidder shall be sure the existing radio cables are placed back in the cab console that run from the patient area to the cab. The body shall be physically removed from the old chassis by removing the old

mounting bolts and discarding them. The entire underside of the body structure shall be fully inspected and photographed. Any damage, cracks or corrosion will be repaired using only OEM components.

5.3. Type Changeover: Transfer Module from Type III to another Type III. Modify suspension and bottom of module as necessary.

5.4. Module Remount: Mount down module squarely on chassis. Remounting manufacturer to use OEM rubber isolators, mounting bolts and transfer body per OEM chassis body builder guidelines. The use of aftermarket or substandard components is strictly prohibited.

5.5. Cab Seal: Install a non-electrolytic rubber gasket between the module and chassis cab back. This rubber seal will be glued in place. This seal interface will eliminate air and water leaks. New stainless steel bolts placed approximately 5" apart will be installed around the entire cab back perimeter properly attaching the cab to the module body.

Does Your Proposal Comply to Specifications: _____ Yes _____ No _____ Deviations Noted

6. New Chassis Preparation

It is the intent of Miller Count Ambulance District that the remounting process, as performed by the vendor, will be to refurbish the ambulance and its components to “like new” condition. Further, it is the intent of this agency that all methods utilized in this process by the vendor comply with all applicable safety standards and guidelines in place for both the model year and that of the conversion. In all manners, the final remount shall meet or exceed any applicable standards in place for all aspects of the remounting process. The remounting vendor is to note their approach to this section and their recommended solution that deviates from the specifications or alternatively exceeds them.

6.1. Springs: As necessary, level each side of modular body to insure proper handling and performance.

6.2. Exhaust Modification: Extend tailpipe to match module width.

6.3. Fuel Tank: Modify fuel tank filler location(s) as necessary to comply with FMVSS and OEM chassis manufacturer's body builder guidelines. This fuel filler shall be clearly and properly labeled. The filler neck supplied by the OEM shall be utilized. The filler neck shall be vented and be diameter indexed to accommodate a fuel pump nozzle. The fuel filler neck shall be bolted to a cast aluminum fill housing. The filler housing shall be an open design with a bright polished mounting flange. The housing configuration and filler installation shall comply with the OEM Body Builders Layout Book. The fuel filler neck shall be grounded directly to the frame rail to prevent static electric charges from igniting the fuel vapors during refueling.

6.4. DEF Tank Filler: The existing module does not have a DEF tank. Therefore, a new DEF tank filler shall be installed in front of the rear axle on the driver's side This modification shall in no way affect the integrity of the module's structure. This modification shall be performed in a professional and OEM manner and be clearly and properly labeled.

6.5. Console: A floor fastened console shall be mounted between the driver and passenger seats for switch, gauges, siren and two-way radios. The floor console should be of a low profile with a design that will facilitate the installation of radios in front and 4” removable, divided pocket in the rear for placement of notebooks. Drink holders, Big Gulp Size, to be located in the rear of the console. Console is to be fastened with Cam-over heavy-duty rubber soft latches. The console shall be a tapered design with a 14 ½” width at the front of the console and a 12” width at the rear. The height shall not exceed the height of the engine cover console measured at the rear. The length of the console, measured at the center, shall be at least 21”. The console body shall be finished with Easy Grip Film as well as bonded to the substrate with high bond contact adhesive. The laminate shall bond tight

to the radius corners and contours of the console body. All joints shall be inconspicuous and bonded along the edges.

6.6. Glove Storage: There shall be glove storage at the rear of the add/on console as part of the add/on console. It shall be designed to hold (4) four boxes of gloves standing on end for easy access.

Does Your Proposal Comply to Specifications: Yes No Deviations Noted

7. Exterior Body Trim

It is the intent of Miller Count Ambulance District that the remounting process, as performed by the vendor, will be to refurbish the ambulance and its components to “like new” condition. Further, it is the intent of this agency that all methods utilized in this process by the vendor comply with all applicable safety standards and guidelines in place for both the model year and that of the conversion. In all manners, the final remount shall meet or exceed any applicable standards in place for all aspects of the remounting process. The remounting vendor is to note their approach to this section and their recommended solution that deviates from the specifications or alternatively exceeds them.

7.1. Diamond Plate: Install all new aluminum diamond plate complete on module body. This will include rub rails, running boards, corner stone guards, plate over wheel wells, and mid body rub rails if equipped.

7.2. Rear Bumper: Install a new all aluminum rear bumper assembly, with center flip-up Grip-Strut@ including new aluminum diamond plate rear kick-plate.

7.3. Fenderettes: A new set of polished fenderettes shall be installed.

Does Your Proposal Comply to Specifications: Yes No Deviations Noted

8. Module Exterior Paint Finish and Lettering

It is the intent of Miller Count Ambulance District that the remounting process, as performed by the vendor, will be to refurbish the ambulance and its components to “like new” condition. Further, it is the intent of this agency that all methods utilized in this process by the vendor comply with all applicable safety standards and guidelines in place for both the model year and that of the conversion. In all manners, the final remount shall meet or exceed any applicable standards in place for all aspects of the remounting process. The remounting vendor is to note their approach to this section and their recommended solution that deviates from the specifications or alternatively exceeds them.

8.1. Prior to any paint and bodywork beginning, all hardware including but not limited to doors, door handles, door stops, emergency lighting, drip rails and all diamond plating is to be removed from the body. All components which are not replaced shall be cleaned and reinstalled upon completion. NO EXCEPTIONS TO THIS REQUIREMENT WILL BE ALLOWED.

The new paint shall match the current paint layout exactly. All paint stripes shall have clear coat along with the entire conversion **NO EXCEPTION.**

After the body has been fully stripped of exterior items, the following steps shall be followed:

- 1) Remove all existing graphics and lettering utilizing 3M prosolver and a rubber buffing wheel.
- 2) Remove all modular entrance and compartment doors.
- 3) Degrease all surfaces with M-600 degreaser
- 4) Sand all areas with 80-grit sandpaper
- 5) Add Quantim 1 body filler as required

- 6) Sand the Quantim 1 body filler with 80-grit sandpaper and feather out with 180- grit sandpaper.
- 7) Blow off the entire surface to remove all the dust from the previous steps.
- 8) Tape/Mask off all the compartments and patient compartment utilizing 3M Masking.
- 9) Apply all bare metal areas with Henkle Alodine Wipes.
- 10) Prime the entire body with Sikkens 650 Surfacer to a minimum of 1.5mil thick.
- 11) Sand entire body with 320-grit sandpaper
- 12) Blow off again, the entire surface to remove all dust
- 13) Re tape if needed any compartments or patient compartment utilizing 3M Masking.
- 14) Paint Sikkens Basecoat and Clear coat to a minimum of 2.5mil thick.
- 15) Bake the painted body at 140°Fah for 35 minutes.
- 16) Sand with 1500-grit dry sandpaper.
- 17) Sand with 2000-grit wet sandpaper.
- 18) If color other than white, may require sanding with 3000-grit wet sandpaper.
- 19) Buff utilizing Mirka A12 and F05 to polished finish.
- 20) Reinstall doors with new door gaskets and mylar tape between the door/body and the hinges.

If the manufacturer’s process does not match this process and components exactly, then the manufacturer shall write their exact process as an exception to this requirement.

8.2. Electrolysis Inspection: Module and exterior fasteners will be inspected 100% for evidence of electrolysis. Such areas will be specially treated to prevent any further damage and remove visible damage. All exterior screws shall be stainless steel.

8.3. Drip Rails: All drip moldings over compartment and entrance doors shall be removed and be replaced with new matching aluminum moldings. Installation of these moldings shall be reattached in the same manor.

8.4. Paint/Graphics: The module body shall be repainted to match the current paint scheme of Miller County Ambulance District. Any stripe on the body or layout design affected by the remount process shall be replaced. The successful bidder shall operate an on-site vinyl graphics department. The computerized equipment shall be state of the art machinery with the capability of printing and cutting up to 60 inches of material. All computer generated materials shall provide a single layered 3M Controlled Release high reflective material with luster laminate protection for longer lasting graphics that won’t separate or delaminate. The purchaser requires pre-approval of the layout with the successful bidder. The warranty for the graphics shall be 7 year/ 70,000 miles. The graphics layout shall match the District’s current design.

8.5. Lettering: Provide and install customer specific lettering. Install KKK, DOT, Ambulance, and Star of Life decals per KKK regulations and State of Missouri requirements. All Miller County Ambulance District identifications and designations shall be reapplied to represent the look of the vehicle before commencement of work.

8.6. The door frame shall have a three quarter inch (3/4") wide white reflective tape applied to the door frame. The tape shall illuminate the outline shape of the door when the door is opened.

Does Your Proposal Comply to Specifications: Yes No Deviations Noted

9. Exterior Compartments

It is the intent of Miller Count Ambulance District that the remounting process, as performed by the vendor, will be to refurbish the ambulance and its components to “like new” condition. Further, it is the intent of this agency that all methods utilized in this process by the vendor comply with all applicable safety standards and guidelines in place for both the model year and that of the conversion. In all manners, the final remount shall meet or exceed any applicable standards in place for all aspects of the remounting process. The remounting

vendor is to note their approach to this section and their recommended solution that deviates from the specifications or alternatively exceeds them.

9.1. Weather Stripping: Replace all door gaskets with original or equivalent seal.

9.2. Compartment Doors: Compartment doors are to be closely inspected for condition and repaired as necessary or replaced. Compartment doors are to be checked and trued for alignment and closure.

9.3. Door Gaskets: All door gaskets shall be replaced, including patient compartment doors and exterior compartment doors.

9.4. Door Handles: All of the modular body doors shall be dismantled including removal of the entry door windows and inner door panels. Remount facility shall replace the existing door handles, hardware, and rotary latch assemblies with new Tri-Mark Free Floating Chrome Door Handles or similar, 1/4" steel rods with antirust zinc plating with 1/4"x20 threads and stainless steel hardware. All door jambs shall also receive new Nader pin(s).

9.5. Door Checks: Door checks shall be replaced with new gas pistons on each door.

9.6. Windows: All windows and gaskets are to be water tested to verify they are sealing correctly and the window gaskets replaced where necessary. Any damaged windows replaced with like OEM windows from OEM manufacturer

Does Your Proposal Comply to Specifications: Yes No Deviations Noted

10. Patient Compartment Flooring, Cabinetry and Fixtures

It is the intent of Miller Count Ambulance District that the remounting process, as performed by the vendor, will be to refurbish the ambulance and its components to "like new" condition. Further, it is the intent of this agency that all methods utilized in this process by the vendor comply with all applicable safety standards and guidelines in place for both the model year and that of the conversion. In all manners, the final remount shall meet or exceed any applicable standards in place for all aspects of the remounting process. The remounting vendor is to note their approach to this section and their recommended solution that deviates from the specifications or alternatively exceeds them.

It is the intent of Miller County Ambulance District to standardize its fleet of ambulances—including the layout of the modules of its ambulances. This standardization will require the 2009 module to be reconfigured to a nearly identical layout of the 2010 module. This configuration is to include altering both upper and lower cabinets located alongside the street-side wall to the same configuration of the 2010 module and incorporate a CPR seat of the same type and in the same location. Additionally, the Stryker Cot Fastening System is to be replaced and relocated to that of a center position and the flooring reinforced as necessary to accommodate these changes and in accordance to accepted manufacturers and safety standards applicable.

10.1. Cot Mount: New Stryker #6370 Cot Mount Setup to be installed and located in the Center Position, Must Maintain 12" between Cot and S/B Stryker Cot Stop Block. Installation to include replacement of cot stop just inside the rear entry doors.

10.2. Cot Fastener Mounting Method: Floor reinforcement to include a minimum of 8" wide by 5' long 1/2" aluminum reinforcement at primary cot position. All mounting bolts shall be 3/8" diameter, socket head cap screws with at least 16 threads per inch. All mounting blocks shall be supplied and manufactured by the cot mount manufacturer. The mounting blocks may protrude above the flooring surface by up to 3/16", as long as all of the edges are chamfered. The cap screws shall not protrude above the upper surface of the mounting block. All cap screws shall be through bolted through 1/2 (.500) inch thick, 6061-T-6 Aluminum plate structure. All cot plate structure shall be continuously welded to the floor structure members. Bolt tapping is acceptable ONLY over blind areas, where through bolting would require removal of the rear fuel tank AND access has been blocked off by permanent, critical structure or components. Mounting bolts shall not point toward fuel filler or fuel vent hoses, in accordance with good engineering practices set forth by the Society of Automotive Engineers.

Bidders shall meet or exceed mechanical strength described in the minimum fastening method. Material thickness and/or through bolt criteria is mandatory even if the vendor has current certification to A.M.D. Standard 004 utilizing lesser materials. (Note: Testing compliance required

10.3. Cot Position No. 1: This cot position shall be setup for a primary wheeled cot set centered laterally (side to side) in the aisle. The longitudinal location shall be set 30 inches measured from the backrest of the attendant’s seat (set all the way toward the front of the patient cabin) to the head of the primary cot frame, per current KKK-A-1822.

10.4. Floor Covering: New floor covering shall be installed and covered up sidewalls for ease of cleaning. Floor shall be color coordinated to the interior color scheme and approved by this agency prior to installation. Floor covering shall be Optima, Dark Gray in color.

10.5. Thresholds: Thresholds are to be inspected and repaired or replaced with satin finish stainless steel sealed for sanitation. There will be 2" non-skid material applied to these thresholds for added safety.

10.6. Upholstery: All upholstery in the patient compartment shall be replaced including cushions pads with 36-ounce vacuum formed seamless material to match the current upholstery. Color will be Blue Ridge.

10.7. Custom Cabinets: Any specially requested cabinets are to be fabricated in a manner consistent with the existing cabinets.

10.8. Cabinets: Cabinets will be checked for sharp edges, defective areas, and professionally repaired including the following items:

- Trim out interior to a like new condition
- Manually check cabinet mounting bolts to insure stability and strength
- Check all shelves for security and make rattle proof
- Check all seatbelts and replace all defective ones
- Replace any damaged or missing trim.
- Replace any rusty or discolored screws or trim
- Replace all damaged Lexan, aluminum window tracks, handles/hardware and felt as needed.
- Provide high quality clean up and sanitation to all cabinetry, compartments, headliner, etc.

10.9. HVAC System: Before any dismantling is performed, excess Freon and Anti-Freeze shall be properly disposed of based on EPA local requirements. The existing HVAC system shall be disposed of and replaced with a new Automotive Climate Control System (ACC), with new nomex heater hoses, A/C hoses and heater valves. The HVAC system shall be tested. The test results shall be documented and provided to the purchaser upon inspection and delivery. New control switches will be provided and included in the schematics.

10.10. Dual AC Control/Thermostat: The air conditioning and heat for the patient cabin shall be controlled by a thermostatically sensitive panel located in both the action area switch console and the cab switch console. The panels shall feature a variable speed fan control, a system "heat-off-cool" switch and a variable temperature control. A digital display shall indicate the patient cabin temperature on both displays.

10.11. Rear Air Conditioning and Heating Modifier Connections: A set of air conditioning and heater tubes shall be routed from the engine compartment to an under body location under the driver’s seat. These tubes shall include a supply and return line for each connection type.

Does Your Proposal Comply to Specifications: _____ Yes _____ No _____ Deviations Noted

11. Electrical System

It is the intent of Miller County Ambulance District that the remounting process, as performed by the vendor, will be to refurbish the ambulance and its components to “like new” condition. Further, it is the intent of this agency that all methods utilized in this process by the vendor comply with all applicable safety standards and guidelines in place for both the model year and that of the conversion. In all manners, the final remount shall meet or exceed any applicable standards in place for all aspects of the remounting process. The remounting vendor is to note their approach to this section and their recommended solution that deviates from the specifications or alternatively exceeds them.

It is the intent of Miller County Ambulance District that the electrical system not be compromised in any manner during the remounting process and that it be restored to new condition and in strict compliance with ALL industry safety standards that may be applicable. All components that comprise the electrical system are to be inspected and replaced where necessary and warranted for a period of no less than three (3) years or 36,000 miles. Any changes to any part of the electrical system are to be restored in the same manner, function, location and operation as the original components. At a minimum the following are to be inspected, installed and/or replaced:

- 11.1. Power Distribution Panel:** Check for 100% complete operation and compliance with any applicable KKK standards and upgrade where necessary to meet compliance. Any compromised components to be replaced. Manufacturer shall provide a minimum of three (3) year/36,000 mile electrical warranty.
- 11.2. Switch Panels:** The cab and action area switch panels shall be replaced with new. The switches, backlighting, legends and panels shall all be new and compatible with the current electrical system.
- 11.3. Rocker Switches:** All rocker switches and relays to be inspected and/or replaced with the same.
- 11.4. Door Switches:** All door switches to be inspected and replaced as necessary to meet or exceed current switches. Switches to be sealed to prohibit moisture intrusion.
- 11.5. Under-hood Harness:** There shall be a new under-hood harness manufactured by the remount facility. The new wiring schematic book shall incorporate the function and codes.
- 11.6. Cab Console Harness:** The cab console harness shall be updated to accommodate the new console and switch panel assembly. The new wiring schematic book shall incorporate the function and codes.
- 11.7. 12 Volt Wiring:** All wires within the ambulance harnesses shall meet current Federal Specification KKK-A-1822. All wire insulation shall be GXL or SXL cross-linked polyethylene. Permanent wire identification and wire function shall be printed on 6” centers along the full length of the wire. Wire conductors shall be stranded copper.
- 11.8. Wiring Protection:** All new wiring shall be protected and run in split 300° Fahrenheit, convoluted high temperature looms. All wire harnesses shall be clamped and routed to eliminate the possibility of cut or chaffed wiring. Grommets made of rubber or plastic shall be used where harnesses pass through metal or wood. Large holes and irregular shaped wire passages shall use automotive edge trim to protect the wire conduit/loom. Wire harnesses shall be neatly clamped away from heat sources, or moving components.
- 11.9. Module Grounding:** A minimum of (4) four new braided ground straps shall be through bolted to the chassis frame and the floor structure of the modular body meeting SAE-J551. The bolts shall be at least 3/8 diameter. A flat washer shall be provided under the head of the bolt and over the strap lug with an internal tooth lock washer.

- 11.10. General Grounding: To comply with current Federal specification KKK-A-1822 plus enhance ground quality and reduce trouble shooting time, all devices wired within the ambulance conversion shall be centrally grounded. Each device shall have a separate ground wire routed to a central buss bar then grounded via fine strand cable to the module body. Local grounds are acceptable only when the device is drawing at or less than 100 milliamps (0.1 amps).
- 11.11. Battery Switch: A Cole Hersee M-284 battery switch, 200 amp fuse and (2) 50 amp reset breakers shall be installed in the cab. Switch to be located on right side of driver’s seat base and wiring schematic is required.
- 11.12. Shoreline: Shoreline inlet to be replaced with 20 amp super auto eject with cover and location same as original.
- 11.13. Outlets/Timers: All 125 outlets and wall-timer switches are to be inspected and replaced as necessary.
- 11.14. Inverter: Inverter shall be inspected for proper function and repaired or replaced as necessary.
- 11.15. Backup Alarm: Backup alarm to be replaced with equal or superior unit with a sound level output of at least 97 to 107 decibels. This alarm shall be activated by shifting into reverse. The alarm enable circuit shall automatically reset when the transmission is shifted out of reverse.
- 11.16. Siren: Siren is to be inspected and replaced as necessary. Siren speakers are to be replaced with 100 watt Federal speakers to be recessed into bumper and siren head/siren/horn switch located in the cab engine cover console. Switch shall select horn/ring output.
- 11.17. Batteries: 2 batteries with a minimum of 750 cold cranking amps located in the drawer of the module are to be replaced along with cables and new chassis battery tie ins.
- 11.18. Spot Light: Hand Held Spot Light, Eagle Eye, Rubber Housing, Hard Wired to the Driver Seat Base.

Does Your Proposal Comply to Specifications: Yes No Deviations Noted

12. Oxygen and Vacuum Systems:

It is the intent of Miller Count Ambulance District that the remounting process, as performed by the vendor, will be to refurbish the ambulance and its components to “like new” condition. Further, it is the intent of this agency that all methods utilized in this process by the vendor comply with all applicable safety standards and guidelines in place for both the model year and that of the conversion. In all manners, the final remount shall meet or exceed any applicable standards in place for all aspects of the remounting process. The remounting vendor is to note their approach to this section and their recommended solution that deviates from the specifications or alternatively exceeds them.

- 12.1. Oxygen System: The oxygen system shall be fully inspected to be sure that the rack is free from damage and is secured in the compartment to comply with AMD 003. Remount facility shall check for leaks and verify oxygen flow to each outlet to comply with AMD 015. There shall be a tag displayed in the oxygen compartment showing the date and test requirements and signed off by the QC Inspector who performed the test and compliance. If the existing rack does not have the strap at the top *of the rack that hooks over the bottle-neck then one must be installed to meet* the bottle retention requirement of the AMD testing.
- 12.2. All oxygen system service hoses, fittings and devices shall be made of nonferrous materials. Hoses used to pipe Medical Oxygen shall be electrically non-conductive, ¼ inside diameter with an abrasion resistant, green colored outer jacket. The hose manufacturers name, part number, inside dimension and working pressure rating shall be permanently marked along the entire length of the hose. All hoses shall have a working pressure rating of at least 250 pounds per square inch, withstand a system test pressure of 150 PSI / 1033 kPa test prescribed in current Federal specification KKK-A-1822. (Note: Testing compliance required)
- 12.3. Oxygen Outlets: All oxygen outlets shall be leak tested and replaced as needed.

12.4. Suction System: Test vacuum lines and outlets for proper operation and repair or replace as necessary.

Does Your Proposal Comply to Specifications: Yes No Deviations Noted

13. Lighting:

It is the intent of Miller Count Ambulance District that the remounting process, as performed by the vendor, will be to refurbish the ambulance and its components to “like new” condition. Further, it is the intent of this agency that all methods utilized in this process by the vendor comply with all applicable safety standards and guidelines in place for both the model year and that of the conversion. In all manners, the final remount shall meet or exceed any applicable standards in place for all aspects of the remounting process. The remounting vendor is to note their approach to this section and their recommended solution that deviates from the specifications or alternatively exceeds them.

- 13.1. The warning lights for the front of the conversion shall be replaced with Whelen 900 Series, Super LED’s. Four of the light heads shall be split red/blue. The center warning light shall be clear. All lenses shall be clear. New chrome flanges shall be installed on any new light heads. All remaining exterior lighting and lenses are to be inspected and repaired or replaced as necessary. Any replacement of any emergency, scene, flood, intersection, clearance or other light is to be of the same manufacturer and size of the original equipment. All activations and functions of exterior lighting is to be the same as the original equipment.
- 13.2. Front/Rear Marker Lights: New front and rear marker lights shall be installed on the front and rear of the conversion.
- 13.3. A new LED third break light shall be installed above the rear entry doors in the same location as the existing. Brake light shall flash five (5) times when brake is applied and then steady burn.
- 13.4. Grill Lights: Warning lights for the grill and intersections shall be replaced with new Whelen, LED lights. Lights must be in compliance with the chassis manufacturer’s airflow requirements around the grill area, and without obstruction to any fender mounted OEM equipment. Lights must be installed and included with the bid price. Lights are to include chrome flanges.
- 13.5. Patient Compartment Dome Lights: All patient compartment dome lights shall be replaced with Kinequip LED dome lights with dual intensities in the ceiling. The domes centers shall be aligned along two, three light banks. The left bank shall provide light directly over the patient; the right bank shall provide light directly over the aisle/squad bench. The dome lights and configuration shall meet current Federal Specifications KKK-A-1822.
- 13.6. Step Well Illumination: A 3” LED clear interior light shall illuminate the curbside step well per the current revision of Federal specification KKK-A-1822. Light shall come on with the curbside door only.
- 13.7. License Tag Light: The license tag area shall be LED illuminated with the parking light circuit.
- 13.8. Warning Lights: Warning light flash pattern shall be “Triple K” compliant. All forward facing white lights shall go out when the vehicle is placed in park.
- 13.9. Six reflectors shall be supplied on the outside of the module body. The reflectors shall be located at skirt line level and the area size shall be at least 3.75 square inches. Each side shall have one AMBER forward reflector

and one RED rearward reflector. The rear of the body shall have one RED reflector, located just above the diamond plate kick plate.

Stick on reflectors: Peterson “Spitfire” B484R and B484A

Locations:

- (2) One each side and front – Amber
- (2) One each side and Rear – Red
- (2) One rear of body – Red.

Does Your Proposal Comply to Specifications: _____ Yes _____ No _____ Deviations Noted

14. Communications:

It is the intent of Miller Count Ambulance District that the remounting process, as performed by the vendor, will be to refurbish the ambulance and its components to “like new” condition. Further, it is the intent of this agency that all methods utilized in this process by the vendor comply with all applicable safety standards and guidelines in place for both the model year and that of the conversion. In all manners, the final remount shall meet or exceed any applicable standards in place for all aspects of the remounting process. The remounting vendor is to note their approach to this section and their recommended solution that deviates from the specifications or alternatively exceeds them.

14.1. Remounting is to provide for the reinstallation of (2) 12 VDC 30 Amp Power Sources for radios:

- (4) Coax Cables
- (2) Radio Cable Conduits 1/5” Diameter w/ pull cable. Two pre-wire antenna coaxial cables delivered to the drivers switch console. There shall be a raceway provided to be able to run radio cable from the cab to the patient compartment.
- Radio power #1: 30A, positive/negative, 10 awg wires with battery switch hot. Location behind passenger’s seat. Radio power #2: 30A, positive/negative, 10 awg wires with battery switch hot. Location behind action area board. Coaxial cable, #1: Type RG-58U, origination point: Roof port #1 located 36” back from the front edge of the module roof and centered side to side. Access thru center upholstery panel, termination point behind passenger’s seat w/36” tail.
- Coaxial cable, #2: Type RG-58U, origination point: Roof port #2 located on the center module roof and centered side to side. Access thru center upholstery panel, termination point behind action area box w/36” tail. Conduit #1: 1.5” with pull wire, conduit origination point: Electrical circuit board cabinet, termination point behind driver’s seat.
- 2 stereo speakers in patient compartment in center pad with volume control in A/A, rear speakers in ceiling liner.

Does Your Proposal Comply to Specifications: _____ Yes _____ No _____ Deviations Noted

1. OPTIONAL EQUIPMENT/PROPOSAL INFORMATION:

In addition to the specifications required and set forth in the previous section, Miller County Ambulance District will consider the following options in addition to the base unit. Each option should include: 1) price inclusive of all installation charges and stated separately and in addition to the base unit price proposed where applicable, 2) make/manufacture, 3) warranty information stated separately. Final determination of which/if any options will be chosen will be at the sole discretion of the Board of Directors and/or their agents.

Option 1: 4 Camera System: Mobile Witness Recorder w/ GPS, Engine Computer Cable Hookup, and (3) Recording Cameras:

- (1) Patient Compartment Bullet Camera, (1) Cab Forward Mounted Camera (Facing the Road), and (1) Camera Facing Cab Instrument Panel. External recording drive to be mounted in secure location to prevent unauthorized access.
- Non-Recording Backup Camera with 7” ASA Monitor Located in Cab in ABS Housing with backup and patient compartment viewing.

Option Price \$_____

Option 2/Snow Chains: On Spot Electric Snow Chains, With Air Tank Located Between the Frame Rails

Option Price \$_____

Option 3/Valve Stem Extensions: Cat Eye System or similar to be installed on rear dual wheels. The valve stem extensions are to be steel braided lines that are held in place with stainless steel brackets. These brackets are to be located in such a way as to provide easy access to both the inside and outside rear tires valve stems for the checking of tire pressure and for the addition of air when required.

Option Price \$_____

Option 4/Child Restraint Seat: Child restraint seat to be incorporated into captains’ seat with 4 point safety harness.

Option Price \$_____

Option 5/Air Horn: A Buell electronic air horn system to be installed and consisting of (1) 12” and (1) 10” air horn installed thru the front bumper. The air horns are to be activated by a white momentary style switch in the front control console, in reach of the driver, when the master emergency switch is in the on position.

Option Price \$_____

CONCEPTIONAL DRAWINGS ONLY: DRAWINGS ARE NOT TO SCALE, ALL MEASURES ARE APPROXIMATE & SUBJECT TO ENGINEERING CHANGE

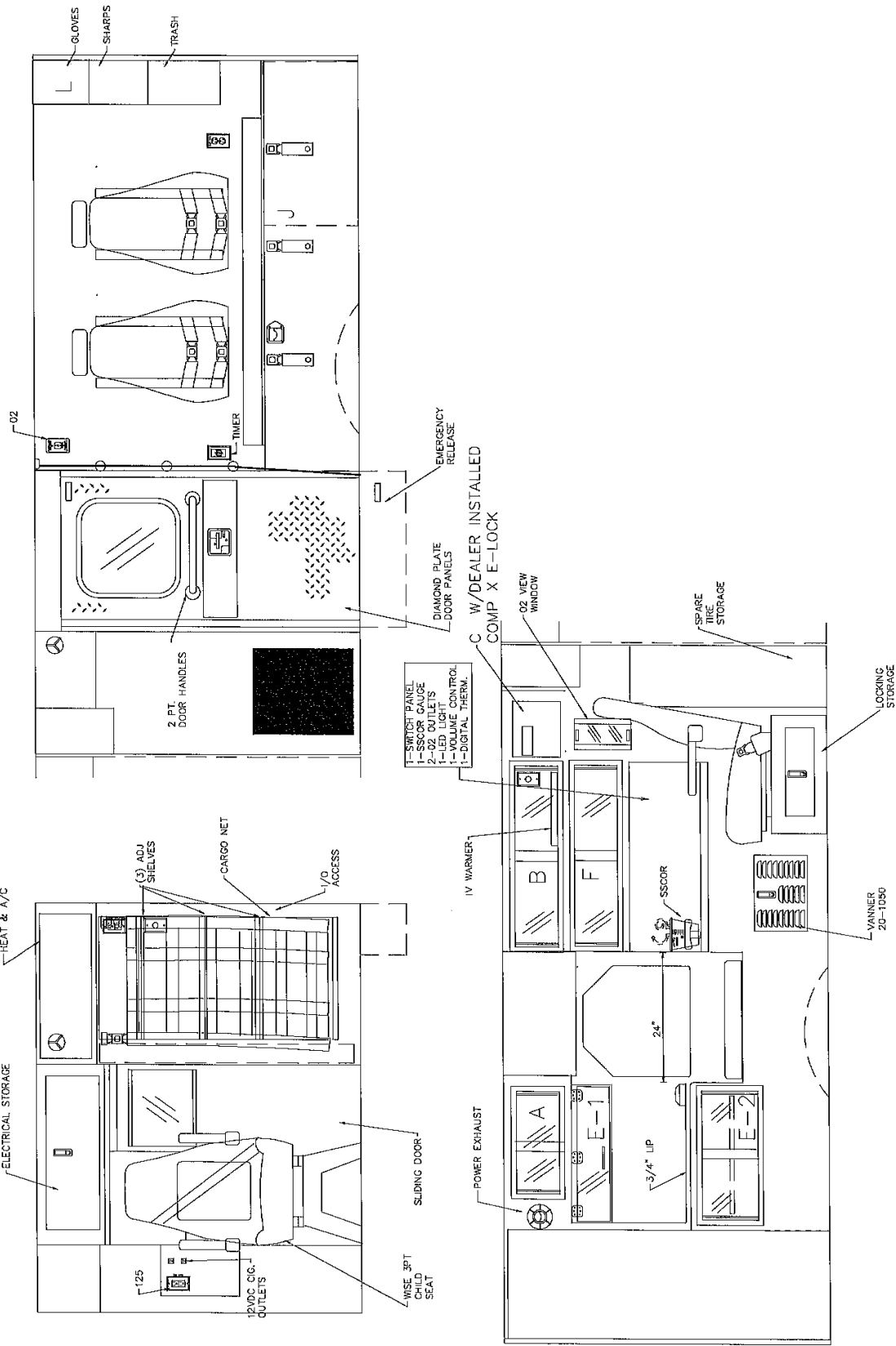

*CONCEPTIONAL DRAWINGS
 * Some shown are optional
 * Due to AEV's ongoing improvements, drawings can change.